



2015

REPORT

LEITNER[®]
ropeways



LEITNER ropeways

Technological excellence and innovative design for maximum comfort





2015 in retrospect

LEITNER ropeways provided technological excellence worldwide in all different areas in 2015, ranging from winter sports through to urban passenger transport in nine countries. Combining high technology, functionality, efficiency, and unique design, ropeways are an innovative and environmentally friendly way to get from A to B. Having pioneered DirectDrive, LEITNER ropeways is unique in boasting 15 years' experience with the gearless drive system. DirectDrive offers numerous benefits, from low consumption and emissions to improved ride comfort. Fifteen new systems were manufactured out with the innovative drive system in 2015 alone.

The latest projects highlight the increasing trend toward excellent ride comfort and modern design. With its stylish gondola melodiously chris-

tened "Symphony" designed by Pininfarina, the most famous vehicle designer in the world, and with the LEITNER Premium Chair, which features expertise drawn from the automotive industry and genuine leather seats, one thing is certain: LEITNER ropeways leads the way. Tailored design elements reinforce customers' branding and communications strategies and give them a key competitive edge. LEITNER ropeways sets new standards in technology and design.

ITALY

More comfort, and not only round the Sella Ronda

The Arabba Fly 6-seater chairlift means winter sports enthusiasts doing the Sella Ronda can now travel in comfort over the village of Arabba instead of having to cross it on foot. Skiers and walkers can now ride to the top of the 3,000-meter-high Presena Glacier from the Passo del Tonale and enjoy the panoramic views. The 6-seater La Fraina chairlift in Alta Badia is equipped with DirectDrive and provides improved links between La Villa and San Cassiano. At the Sella Pass, the Piz Sella 6-seater chairlift has replaced a 2-seater system. The Jaufen Lift 4-seater chairlift at the Jaufen Pass features stylish seats, blue bubbles and the DirectDrive. New ropeways were put into service in Ponte di Legno and Campobasso.

AUSTRIA

The leading ski resort in the world can now offer guests a level of comfort to match thanks to the Premium Chair.

The partnership between LEITNER ropeways and Bergbahn AG Kitzbühel goes back many years and now has another highlight in the shape of the CD8C Brunn with DirectDrive. This is the first system to feature the new LEITNER Premium Chair, built using state-of-the-art technology from the automotive industry. Also new in Kitzbühel is the Bichlalm 2-seater chairlift. The new CD6C Scherthannbahn in Hopfgarten in the Brixental demonstrates significant improvements. Comfort seats and individual color schemes with blue bubbles are more than visual highlights.

DirectDrive and the automatic elevating platform substantially enhance ride comfort for the guests.



Zermatt / Switzerland



Gällivare / Sweden

SWITZERLAND AND FRANCE

Modern, individual design created with sustainability in mind

The Sogn Martin–La Siala GD10 gondola lift in Laax is the perfect example of how sustainability, design, and high technology can be combined. It features cabins designed by Pininfarina and stations made of wood from Grisons as well as the innovative DirectDrive. Zermatt Bergbahnen has also embraced the gearless drive system. Their new Joscht–Hirli 6-seater chairlift also features blue bubbles. Patron of the chairlift is top skier Lara Gut, whose photo adorns the upholstery. In France, LEITNER installed a system featuring LeitDrive and DirectDrive for the private company Les Arcs – Paradiski (Compagnie des Alpes). The system can run at 6 meters per second, enabling a high transport capacity.

GERMANY

Family-friendly and extremely comfortable

Modern ropeways focus rigorously on comfort and safety, as the CDC6 Zeigerbahn in St. Blasien on the Feldberg mountain in the Black Forest amply demonstrates. The features of this particularly family-friendly ropeway include an elevating platform that detects the presence of child passengers and automatically adjusts the entry height. In addition, the system has an important interconnection function between the center at the top of the pass and the installations on the Feldberg. Not only does the new Poppenberg 8-seater in the Winterberg ski lift carousel offer a very comfortable ride – its transport capacity has also been doubled to 4,000 passengers per hour, making it the highest-capacity chairlift in Germany.

SCANDINAVIA

High technology at high latitudes

LEITNER has built the first-ever detachable system north of the Arctic Circle at Sweden's Gällivare ski resort. The CD6 Dundret is the resort's principal system and LEITNER's first installation in the region. With the CD6 Romme Syd, long-standing customer Borlänge, near Stockholm, has made a significant improvement to a key transport link. Its compatriot Vemdalen has also used LEITNER ropeways for many years, with its new CD6 Hovde Express now providing racers with much better training conditions. In Finland and Norway, LEITNER ropeways installed a number of new surface lifts.

CZECH REPUBLIC

Comfort padding, seat heating, and colorful bubbles

One of the most popular ski resorts in the country, Špindlerův Mlýn in the Giant Mountains, relies on technology and design from LEITNER ropeways. Its new CD6C Pláň features DirectDrive and spoils passengers with comfort seats that include seat heating, individual footrests, and blue bubbles. DirectDrive is also the system of choice in Černá Hora, the largest Czech ski resort. With its blue bubbles, black-blue comfort padding and heated seats the CD6C Hofmanky Express is more than just pretty to look at. It is the first chairlift in the Czech Republic to carry winter sports enthusiasts at speeds of 6 meters per second.



Denizli / Turkey



Santiago de Cali / Colombia

ROMANIA

The first DirectDrive in the Carpathians

Ski resorts in Eastern Europe are increasingly turning to modern ropeway technology from LEITNER ropeways. The GD8 Sinaia gondola lift in the Furnica Peak Sinaia ski resort is Romania's first ropeway fitted with DirectDrive and has significantly boosted capacity at the resort. Located in the Prahova Valley in the Carpathian Mountains, Sinaia boasts 22 km of ski slopes at altitudes of between 880 and 2,000 meters and is one of the most popular places to ski in Romania. Building this system was particularly challenging, especially since the ropeway crosses a valley about 100 meters deep.

BULGARIA

Modern technology for the leading resort in the country

Skiing is becoming increasingly popular in Bulgaria as well. With over 70 km of ski slopes at heights of up to 2,000 meters, the southwestern resort of Bansko near the Greek border is the country's leading ski area. The infrastructure has seen considerable investment in the last few years, most recently with the Todorka 6-seater chairlift. It is LEITNER ropeways' first system of this sort in the popular ski resort. Bansko has already hosted several World Cup races.

TURKEY

Eurasia's largest urban ropeway

The 10-passenger Yenimahalle gondola lift in Ankara underlines the importance of urban systems from LEITNER ropeways in Turkey. It connects the Sentepe and Yenimahalle areas of the city with the metro network, taking traffic off the roads and enhancing people's quality of life. The final section of Eurasia's largest urban ropeway was put into operation in 2015. In Denizli, a provincial capital in western Turkey, locals and visitors can take a new gondola lift from the city up to a mountain popular for its panoramic views. Meanwhile, the main attraction of the new residential and shopping precinct in Sinpas near Ankara is a year-round ski slope with special plastic mats and a new 2-seater chairlift.

COLUMBIA

New horizons for the people in the favelas

With the GD10 Miocable in Santiago de Cali, Colombia's third-largest city, LEITNER ropeways has installed another strategically and politically important urban ropeway in the country. Roughly two kilometers long, the new system connects Siloé, one of the poorest districts in the city, with the public transport network, reducing travel time from 45 minutes to nine. Poor infrastructure and the vertical distances between Siloé and the city center had previously posed a great obstacle. The ropeway is giving locals better access to schools and places of work, opening up new, highly promising prospects for them.



Outlook for 2016

WINTER SPORTS

Experiencing a unique level of design and comfort

Ride comfort is becoming increasingly important to winter sports enthusiasts, a trend that is set to continue in 2016 with the opening of many new ropeways. Italy's first 8-seater chairlift with the LEITNER Premium Chair will be built in Ratschings/Alto Adige, and a chairlift with the Premium Chair was selected for the Fellhorn in Germany. Two new gondola lifts are being built in Bellamonte in Val di Fiemme and Roccaraso in Abruzzo, each with DirectDrive. Since June 2015 construction has been underway on the spectacular 3S Eisgratbahn at the Stubai Glacier. Starting in October 2016, it will offer considerably more comfort with the

Pininfarina-designed "Symphony" gondola. A tricable gondola lift is also being built in Zermatt. Scheduled to open by 2018, it will be the world's highest 3S gondola lift.

BOOSTING TOURISM WITH SOME ALTERNATIVE USES

Coming face to face with bears and riding the waves

More and more tourist attractions are discovering the benefits that ropeways offer as a transport system. The Cabárceno Nature Park in Spain is a good example of how efficient transport can be combined with new attractions. Visitors can glide over the park in 8-seater gondolas while enjoying delights such as a bird's-eye view of the world's largest bear

sanctuary. In Verona, tourist attractions are combining tradition with the demands of modern infrastructure. The new inclined elevator at the historic Castel San Pietro will add to the appeal of this popular attraction. In Torreón in northern Mexico, a GD8 gondola lift is under construction in the city. In 2015, LEITNER ropeways joined forces with Wavegarden, the market leader in artificial wave generation, to develop a system to create the world's longest artificial surfing wave using DirectDrive. The first perfect waves are already rolling at the "Surf Snowdonia" water park in North Wales. The first inland surfing facility in the USA is currently being built in Austin, Texas, and is also powered by DirectDrive.

URBAN PASSENGER TRANSPORT

No traffic jams and lower emissions

Around the world, systems from LEITNER ropeways do an important job solving traffic problems in cities. One example can be found in the Ecatepec district of Mexico City, where two interlinked 10-passenger gondola lifts are being built. In Berlin, work is under way on the 1.5 kilometers of ropeway to bring visitors to the 2017 International Garden Show swiftly to their destination. A shopping complex is being built near Kuala Lumpur in Malaysia featuring the 10-passenger Awana Skyway gondola lift, which will provide a link that is both efficient and spectacular. The ropeways in Berlin and Kuala Lumpur will also be major tourist attractions.

**Examples of
365 working days ...**





GD10 MIO CABLE

Santiago de Cali / CO

Inclined length	2037 m	Power	525 kW
Vertical rise	65 m	Total number of vehicles	90
Transport capacity	3000 p/h	Total number of towers	14

Since September 2015, the new gondola lift has connected Siloé, one of the city's poorest districts, to the public transport network, giving the 120,000 residents in the suburb of Santiago de Cali much better access to the center. The journey now only takes nine minutes instead of a good three-quarters of an hour, as it did previ-

ously. This makes it much easier for residents to reach workplaces and schools, thus significantly improving their living conditions. The poor infrastructure in the district and the city's vertical distances previously posed both a transportation and a social problem.

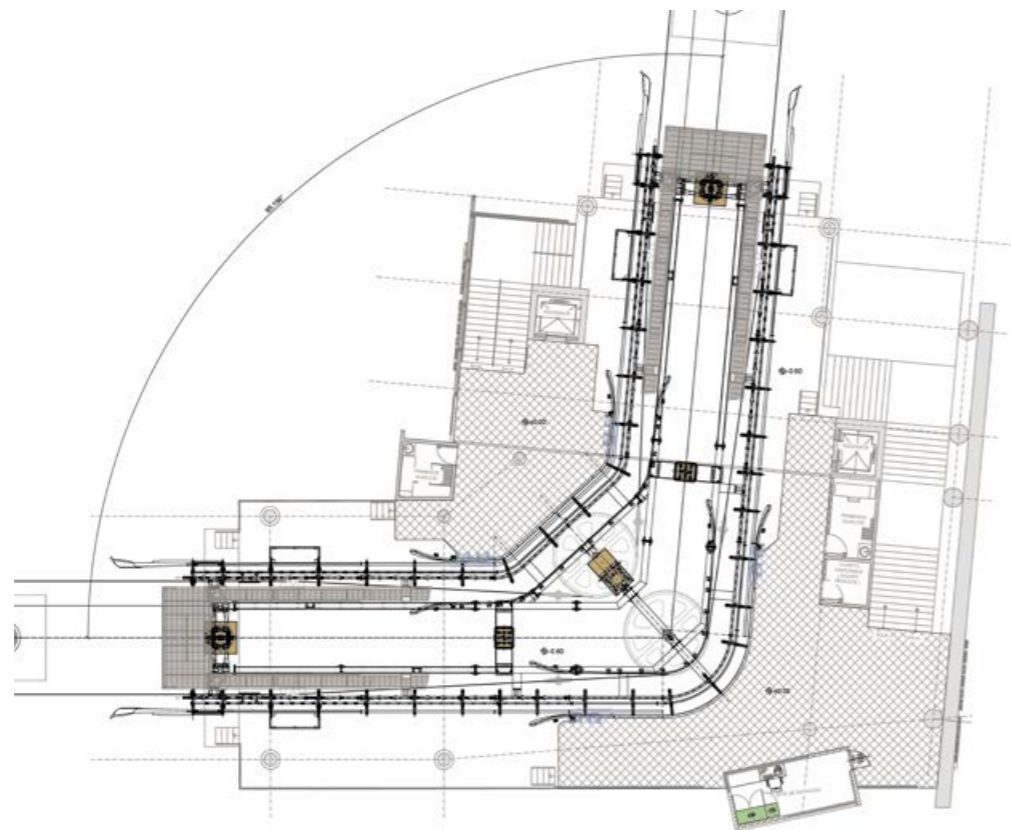





GD10 YENIMAHALLE III

Ankara / TR

Inclined length	1879 m	Power	700 kW
Vertical rise	72 m	Total number of vehicles	54
Transport capacity	2400 p/h	Total number of towers	13

Instead of waiting in traffic jams, the residents of Ankara can now just hop onto a ropeway. Over the course of four stations, the detachable ten-passenger gondola lift Yenimahalle links the district of Şentepe with the center. This way of connecting the district to local public transport significantly eases traffic congestion. The

cabins, equipped with seat heating, multimedia information systems and external lighting, offer an impressive view from up to 60 meters above the ground. In building Eurasia's biggest urban ropeway, LEITNER ropeways is reinforcing its leading role as a manufacturer of ropeways in urban settings.

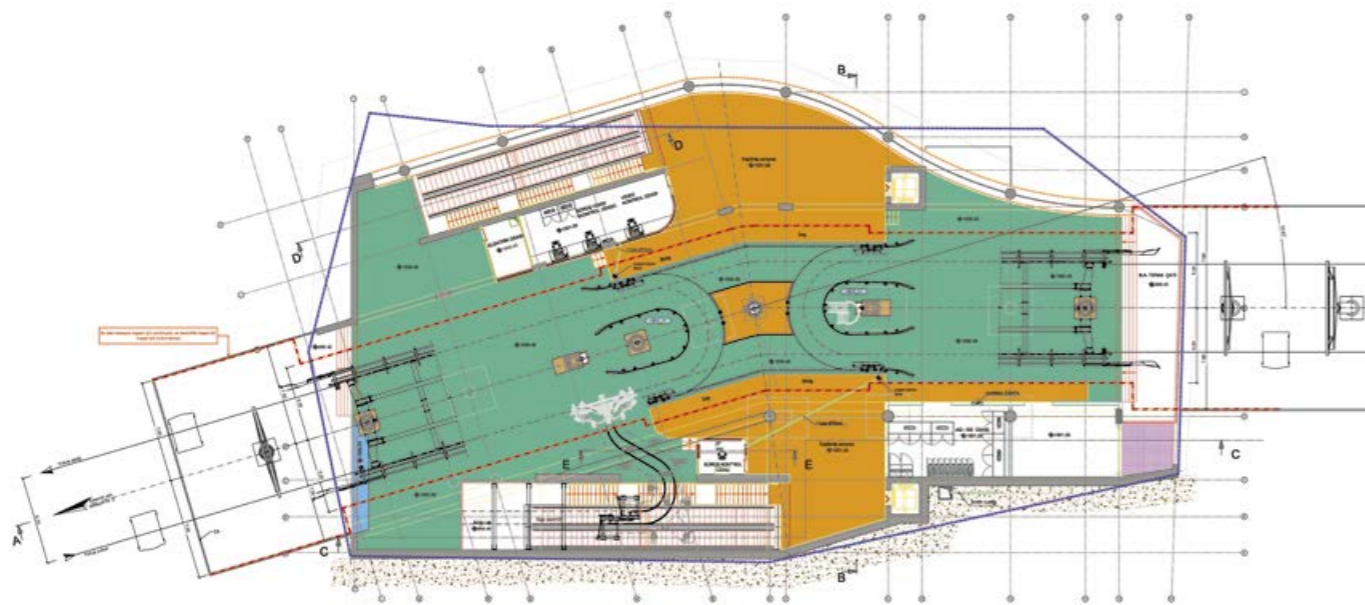





GD10 SOGN MARTIN - LA SIALA

Laax / CH

Inclined length	3366 m	Power	860 kW
Vertical rise	832 m	Total number of vehicles	84
Transport capacity	2400 p/h	Total number of towers	18

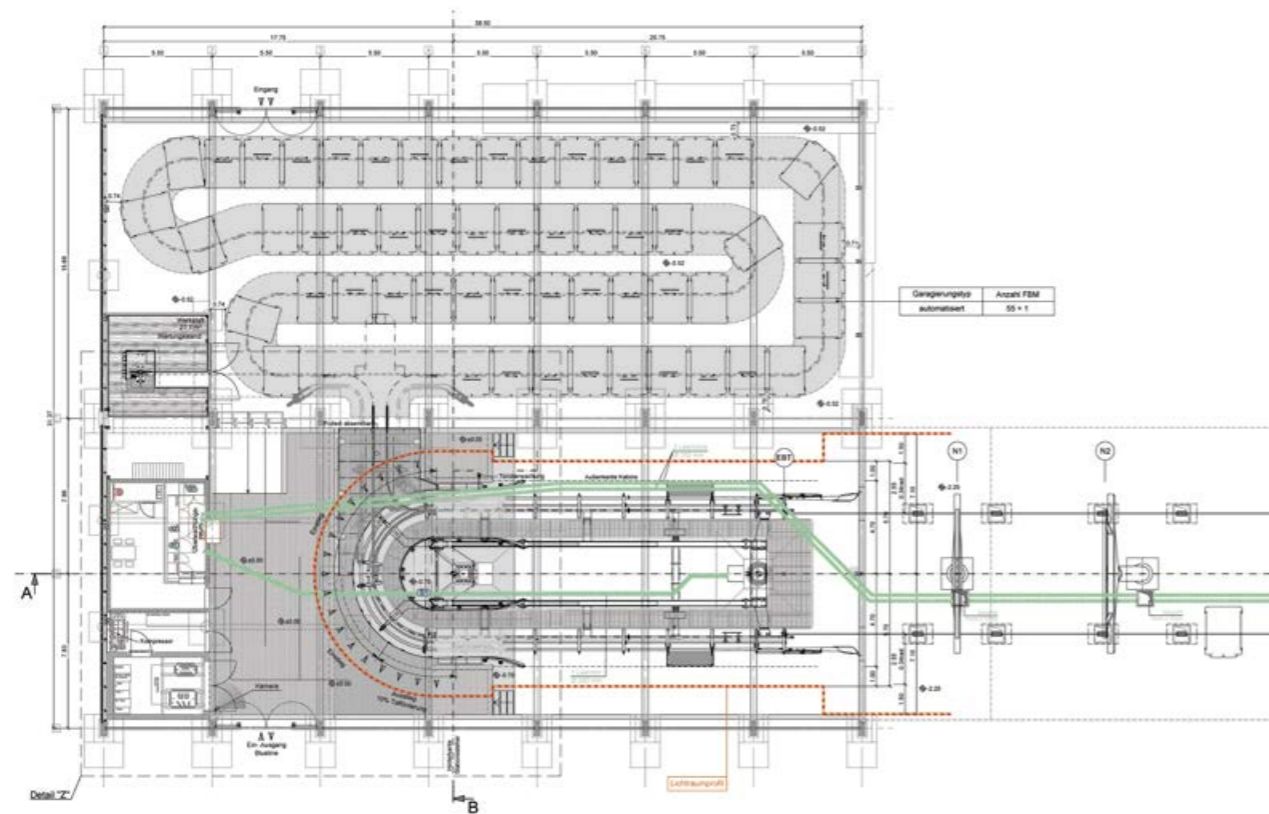





GD8 PASSO PARADISO - PASSO PRESENA

Vermiglio - Passo Tonale / IT

Inclined length	2118 m	Power	445 kW
Vertical rise	404 m	Total number of vehicles	47
Transport capacity	1875 p/h	Total number of towers	11

Thanks to the third system to be built by LEITNER ropeways in Ponte di Legno, skiers and hikers can now conveniently travel by gondola lift 3,000 meters up to Passo Presena.

Passengers can now use the gondola lift for ten months of the year, making the glacier region accessible to all and offering a breathtaking view over the Adamello-Presanella Alps.

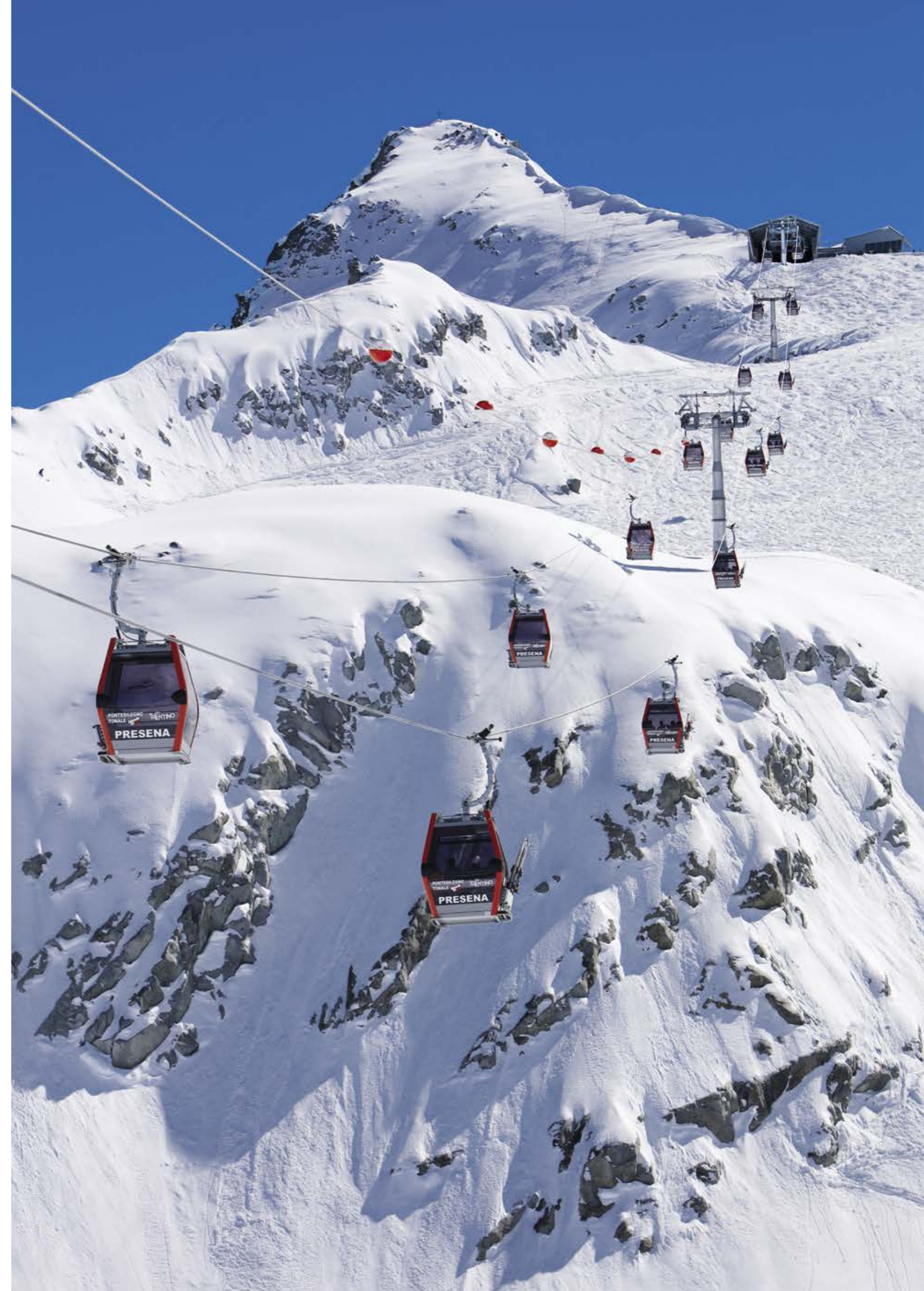
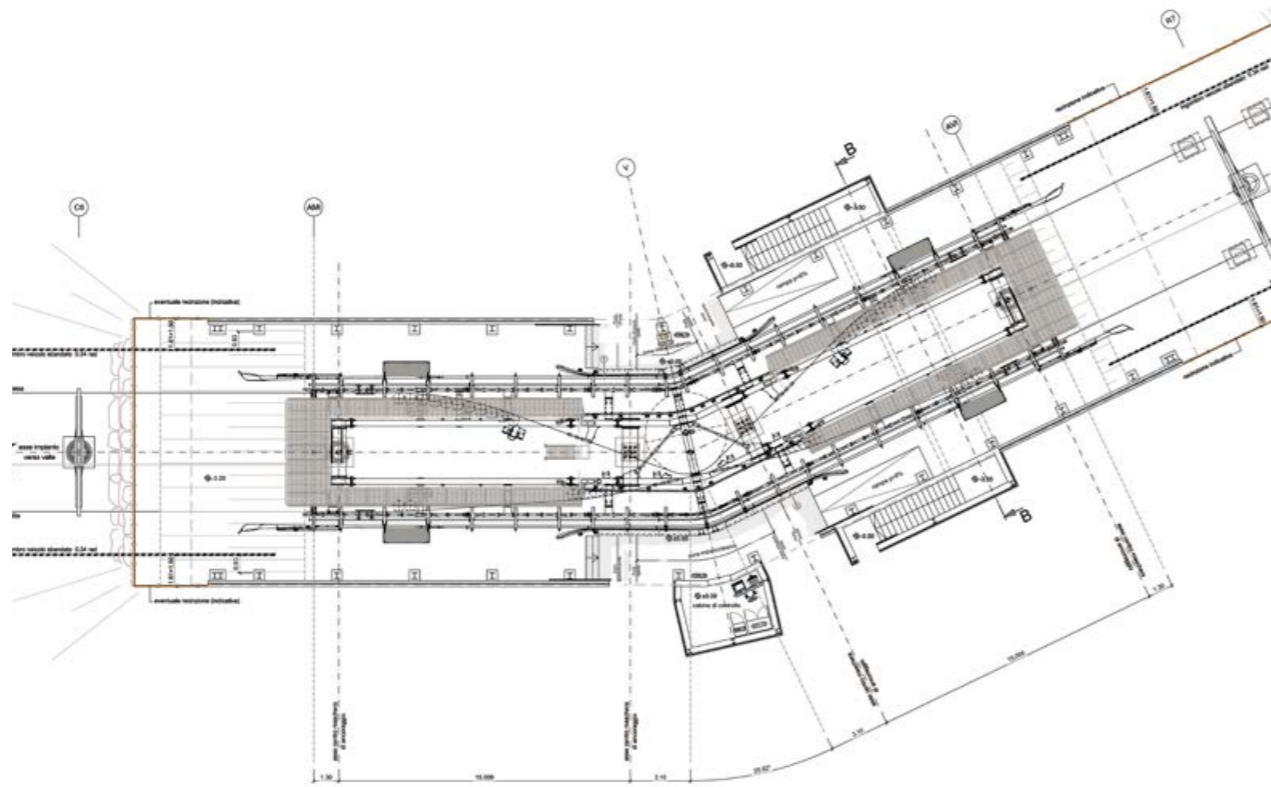





GD8 SINAIA

Furnika Peak / RO

Inclined length	2068 m	Power	507 kW
Vertical rise	630 m	Total number of vehicles	42
Transport capacity	1514 p/h	Total number of towers	12

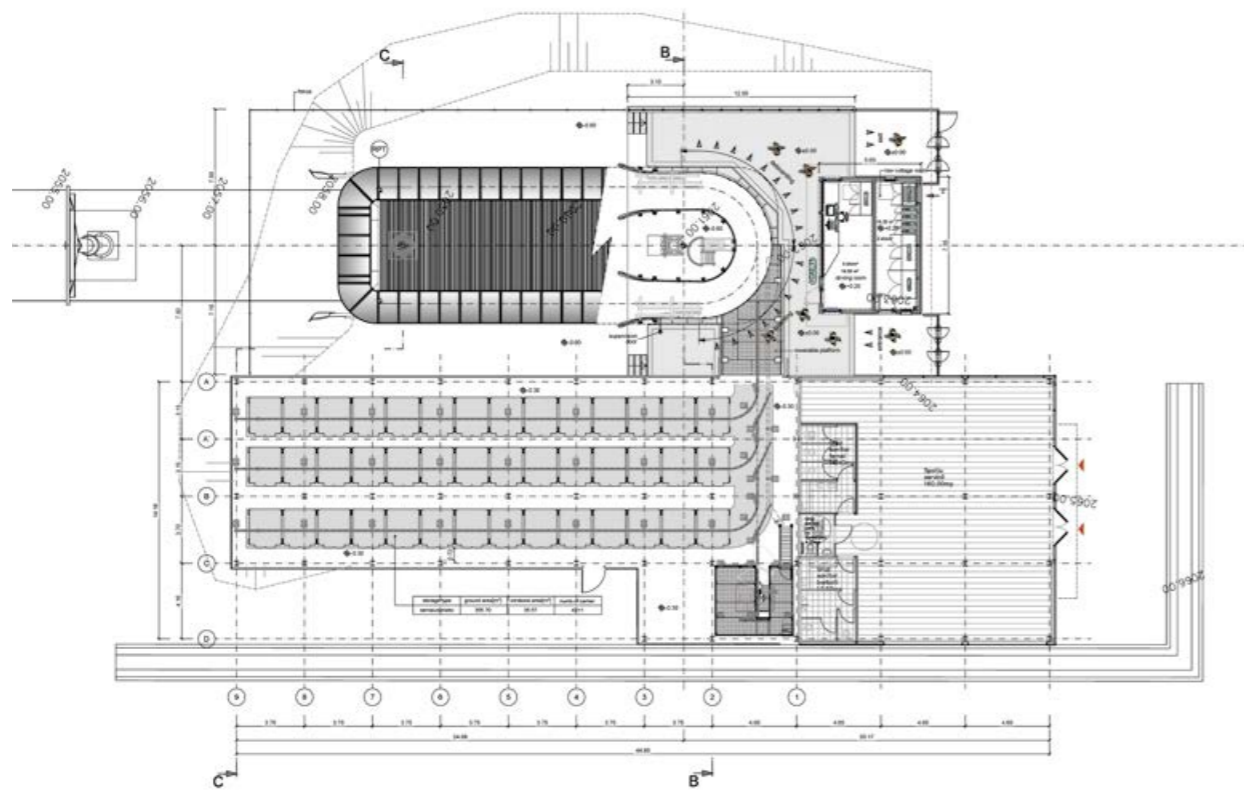





GD8 DENIZLI

Denizli / TR

Inclined length	1610 m	Power	334 kW
Vertical rise	625 m	Total number of vehicles	24
Transport capacity	948 p/h	Total number of towers	9

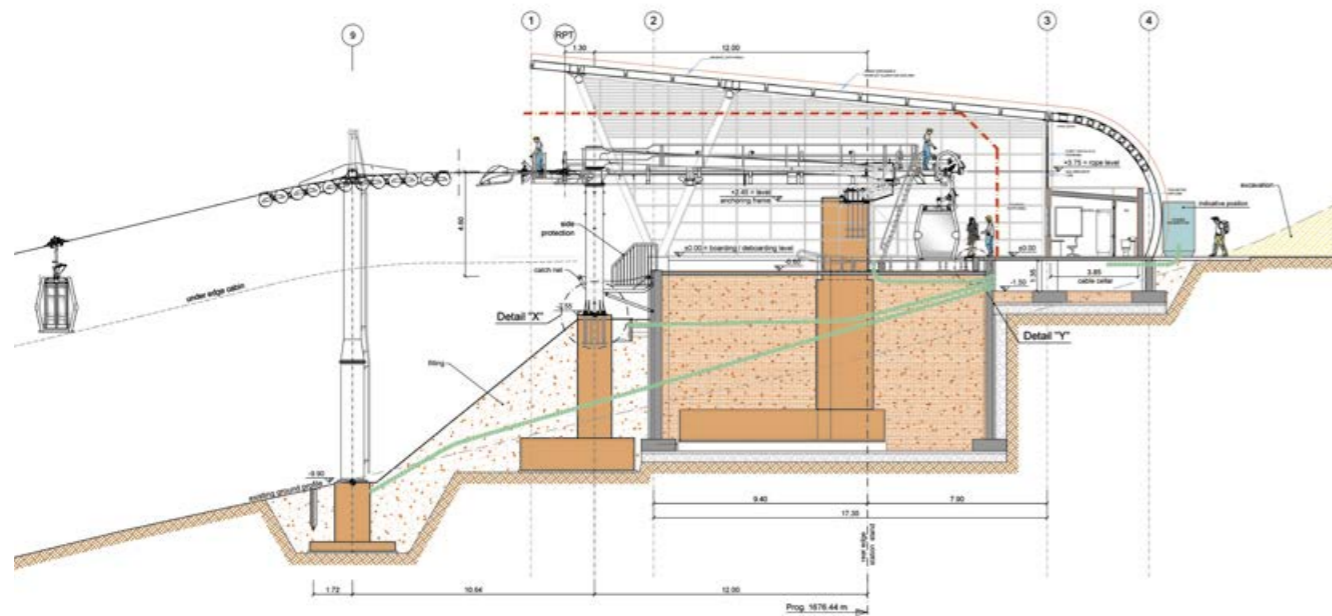



CD8C BRUNN

Kitzbühel / AT

Inclined length	1462 m	Power	775 kW
Vertical rise	432 m	Total number of vehicles	62
Transport capacity	3300 p/h	Total number of towers	17

Elegant design and expertise from the automotive industry: With its fusion of high-end design and unparalleled comfort, LEITNER ropeways has elevated chairlift seating to luxurious new heights. This high-quality Premium Chair made its debut on the new Brunn eight-seater chairlift. Design elements and expert knowledge

from the world of automotive engineering were woven into the development of the LEITNER Premium Chair. The seats feature an ergonomic design and real leather upholstery, the combination of genuine leather slip-proof seats and the lockable safety bar also ensures the very highest levels of safety for passenger transport.

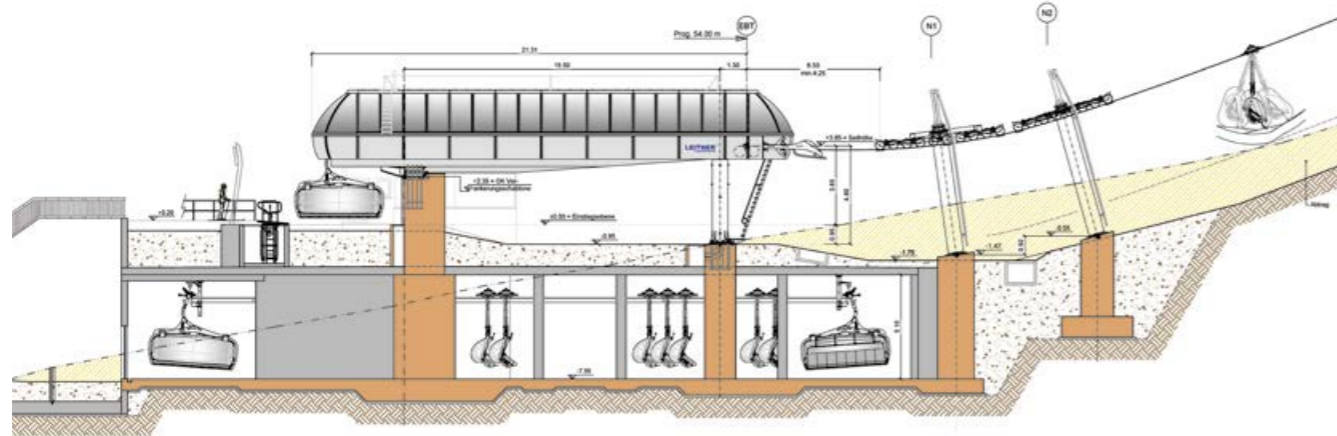





CD8 POPPENBERG

Winterberg / DE

Inclined length	472 m	Power	280 kW
Vertical rise	103 m	Total number of vehicles	37
Transport capacity	4000 p/h	Total number of towers	6

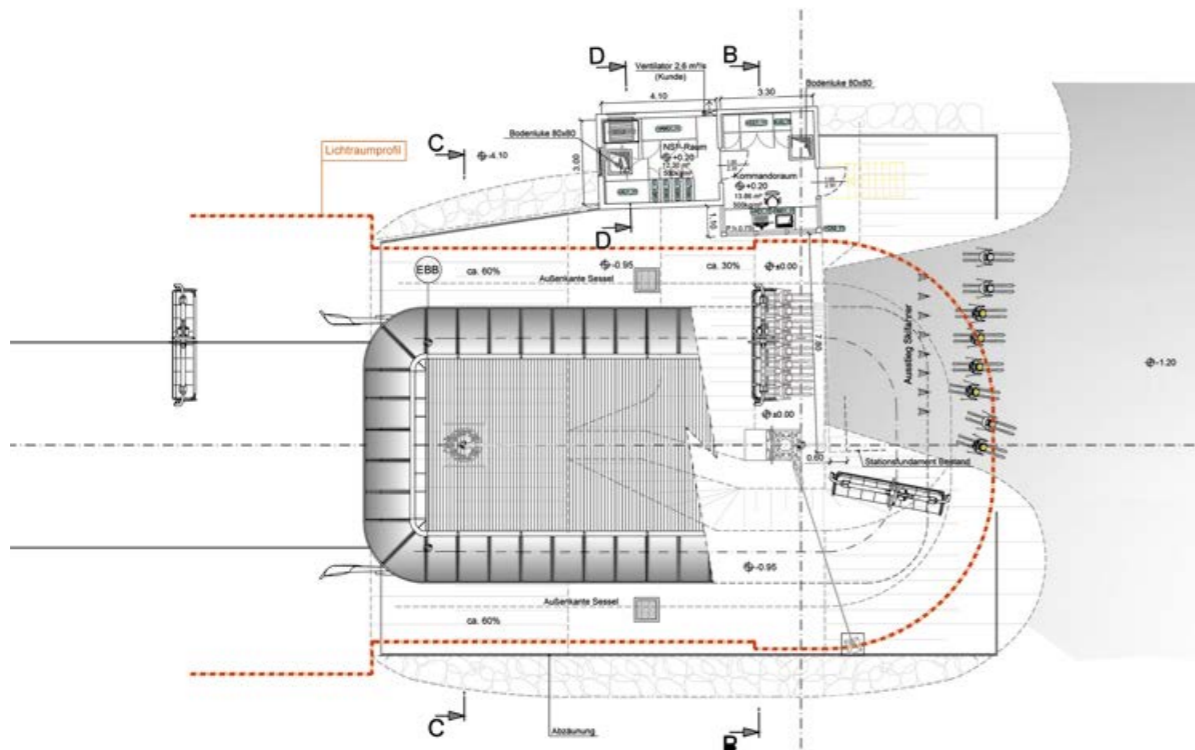



CD6C JOSCHT - HIRLI

Zermatt / CH

Inclined length	2124 m	Power	611 kW
Vertical rise	699 m	Total number of vehicles	72
Transport capacity	2000 p/h	Total number of towers	17

With a top speed of six meters per second, this innovative LEITNER ropeway is one of the fastest chairlifts in Switzerland. Its comfortable powder-coated seats, which are protected by blue bubbles, make the ride a pleasant experience. Locking footrests and the kidstop

system ensure that children can travel safely on the ropeway. Ski racer Lara Gut from Ticino is patron of the new chairlift and has her own seat. A specially designed seat on the chairlift is dedicated to the elite athlete and has upholstery printed with her photo.

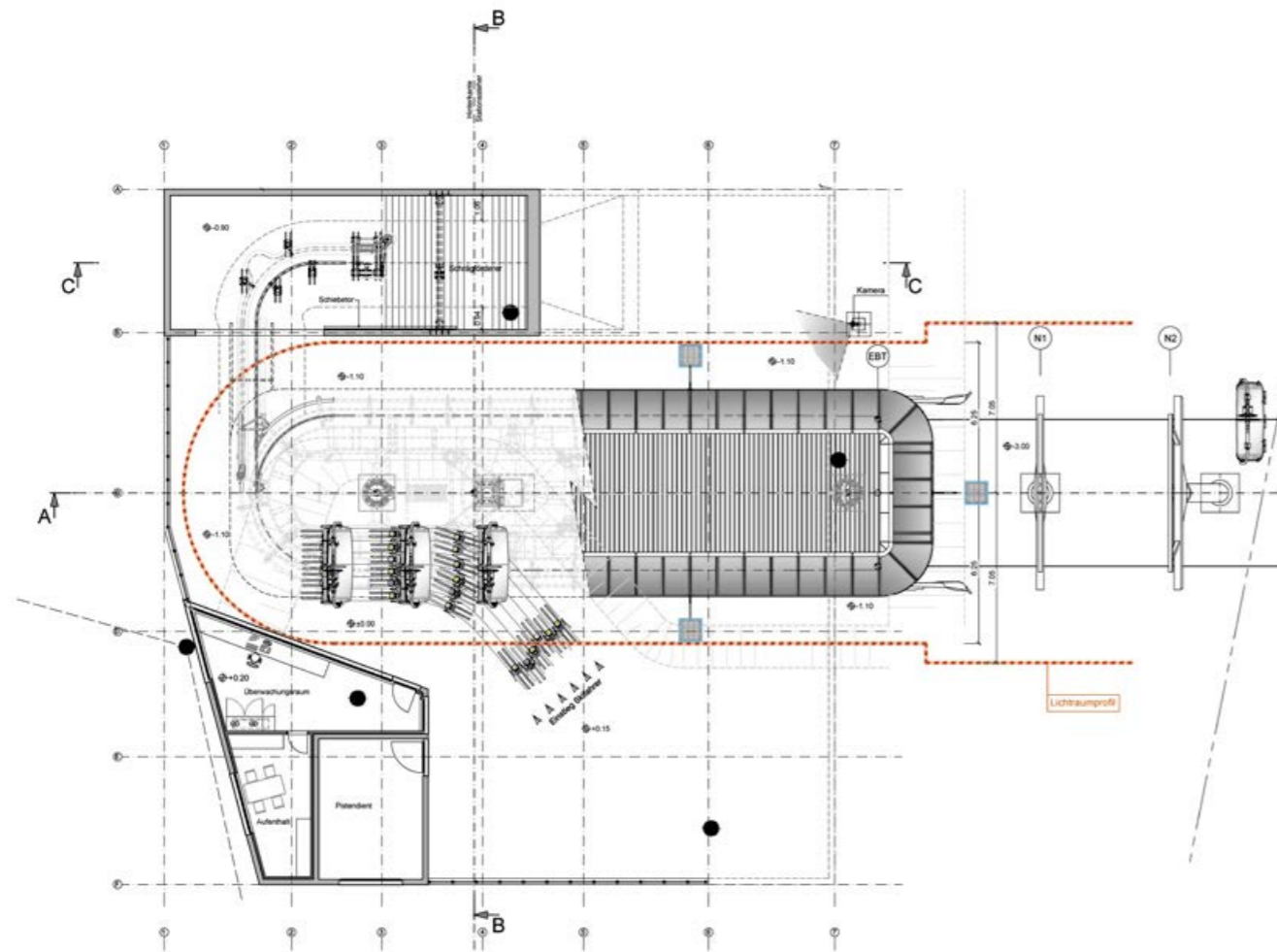

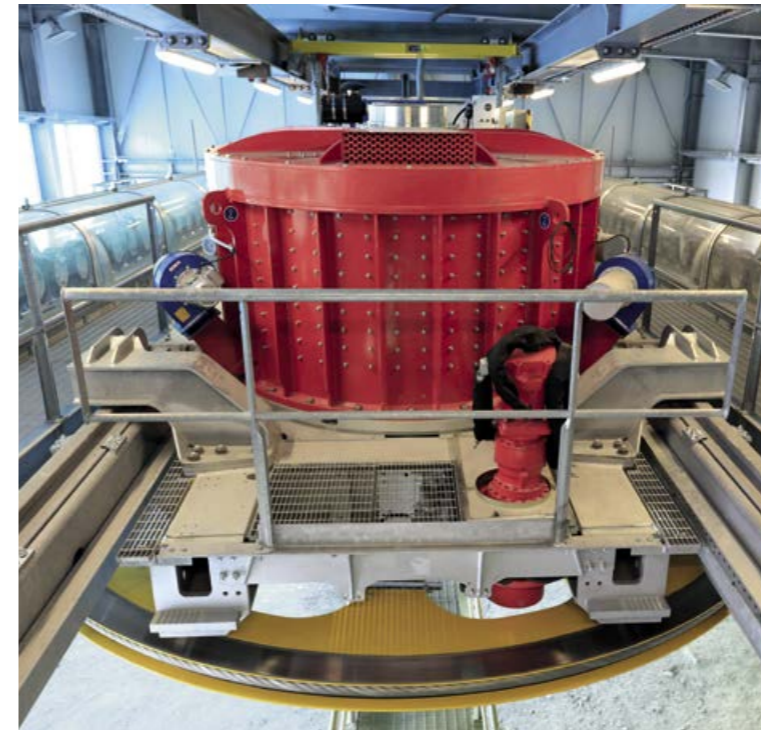



CD6C SCHERNTHANNBAHN

Hopfgarten im Brixental / AT

Inclined length	1273 m	Power	427 kW
Vertical rise	387 m	Total number of vehicles	61
Transport capacity	2365 p/h	Total number of towers	11

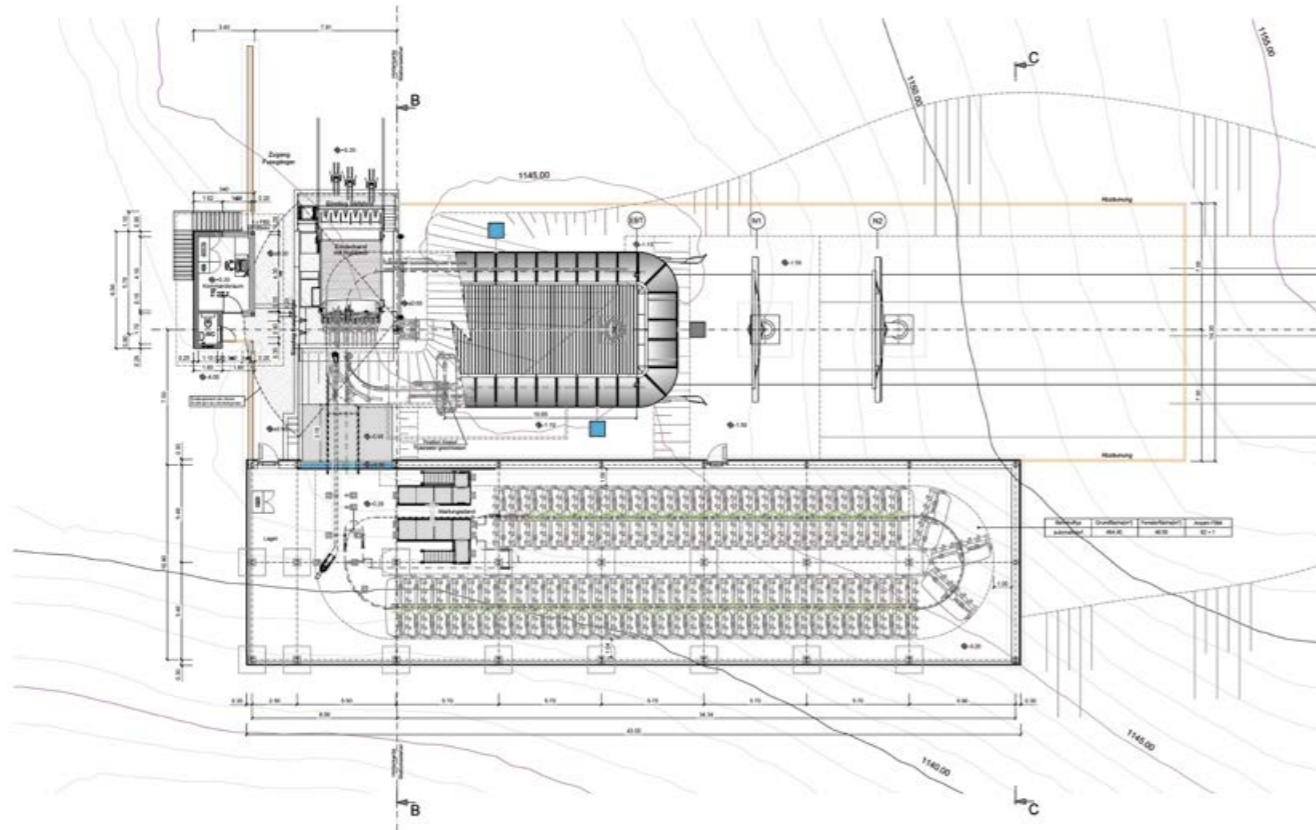





CD6C ZEIGERBAHN

St. Blasien / DE

Inclined length	1188 m	Power	296 kW
Vertical rise	203 m	Total number of vehicles	59
Transport capacity	2400 p/h	Total number of towers	9

On the slopes of the Feldberg in the High Black Forest, the Zeiger lift plays an important role in St. Blasien, connecting the center at the top of the pass to facilities around the mountain and transporting visitors to the popular Zeiger slope. The new ropeway provides technical innovation as well as numerous

benefits for passengers. Thanks to its unique DirectDrive system and automatic elevating platform, the six-seater chairlift offers exceptional comfort and safety for skiing enthusiasts both young and old. The subtle color scheme with blue hoods and comfortable, two-tone padding also visually enhances the ski resort.

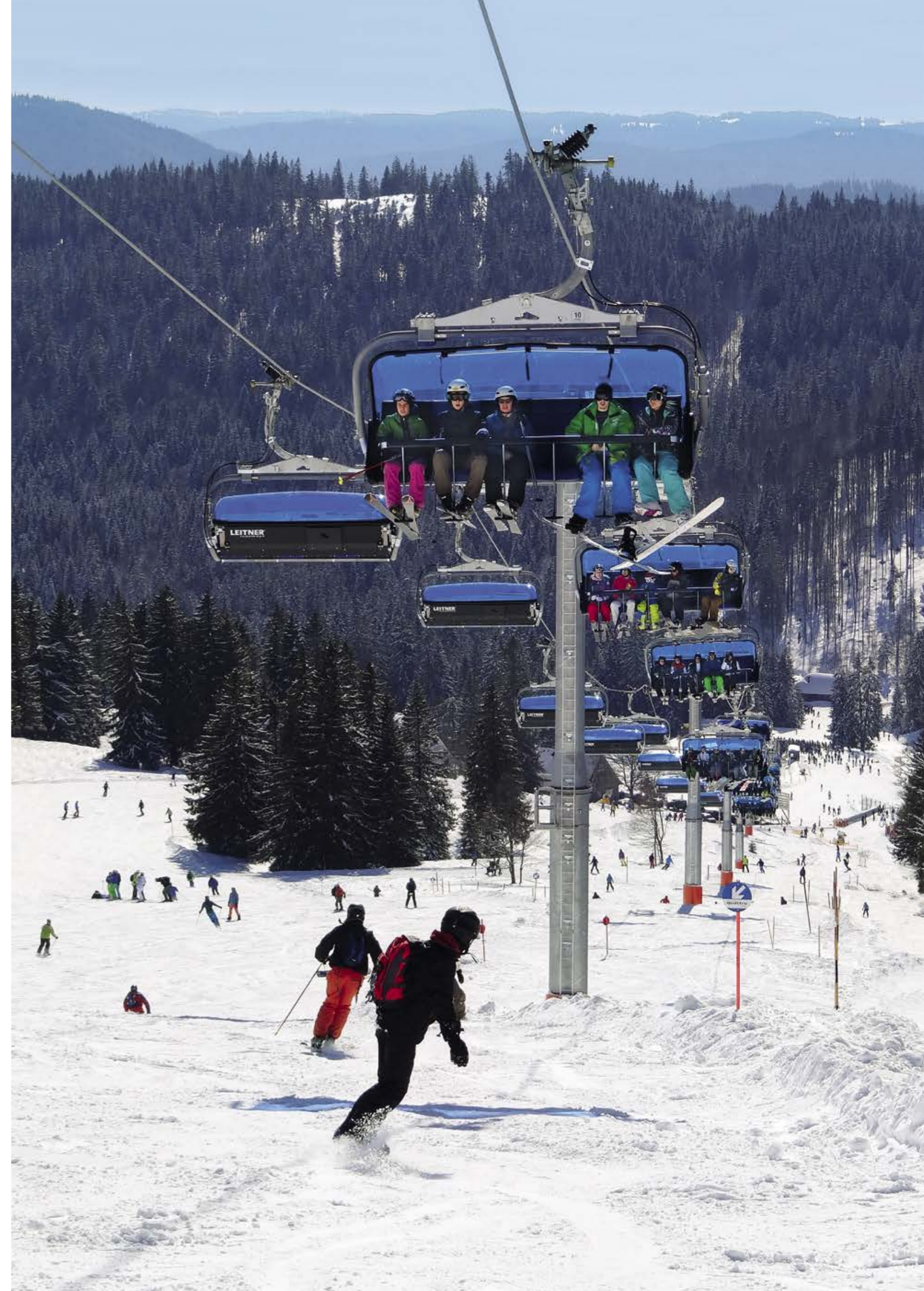
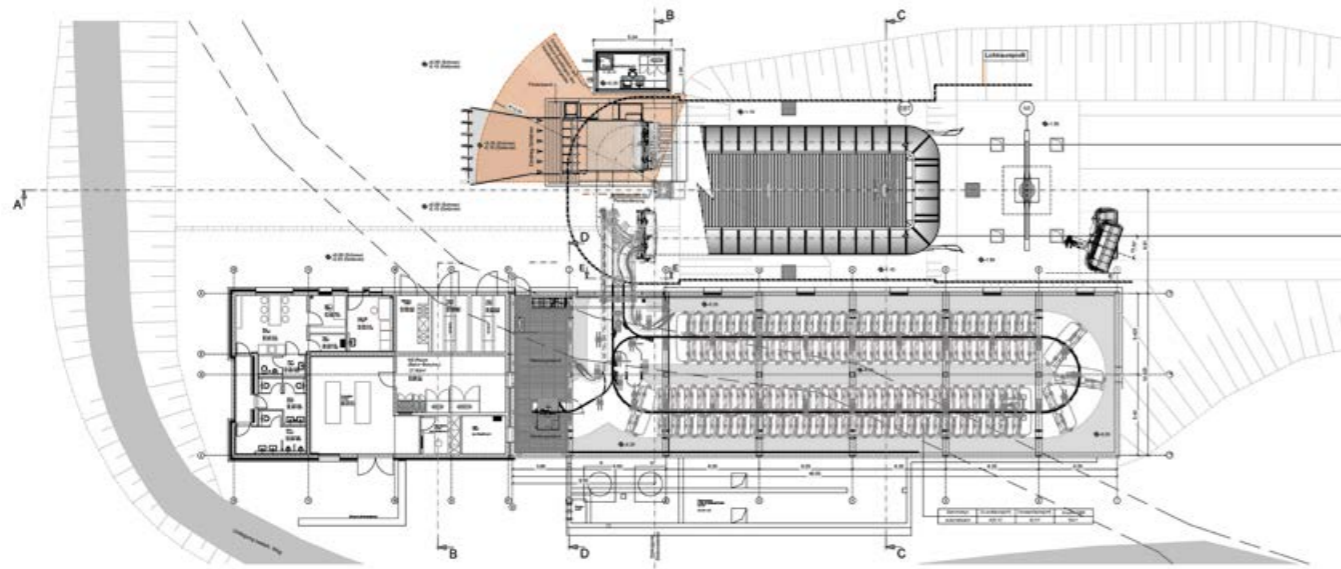





CD6 PIZ SELLA II

Selva Val Gardena - Plan de Gralba / IT

Inclined length	325 m	Power	170 kW
Vertical rise	86 m	Total number of vehicles	26
Transport capacity	2800 p/h	Total number of towers	5

On the Sassolungo above the Sella Pass in the Dolomite mountains, the six-seater Piz Sella II chairlift - only 325 meters long - is replacing a 30-year-old two-seater lift, offering a signifi-

cantly more comfortable ride. With an inclined length of 325 meters, this facility is Italy's shortest detachable chairlift.

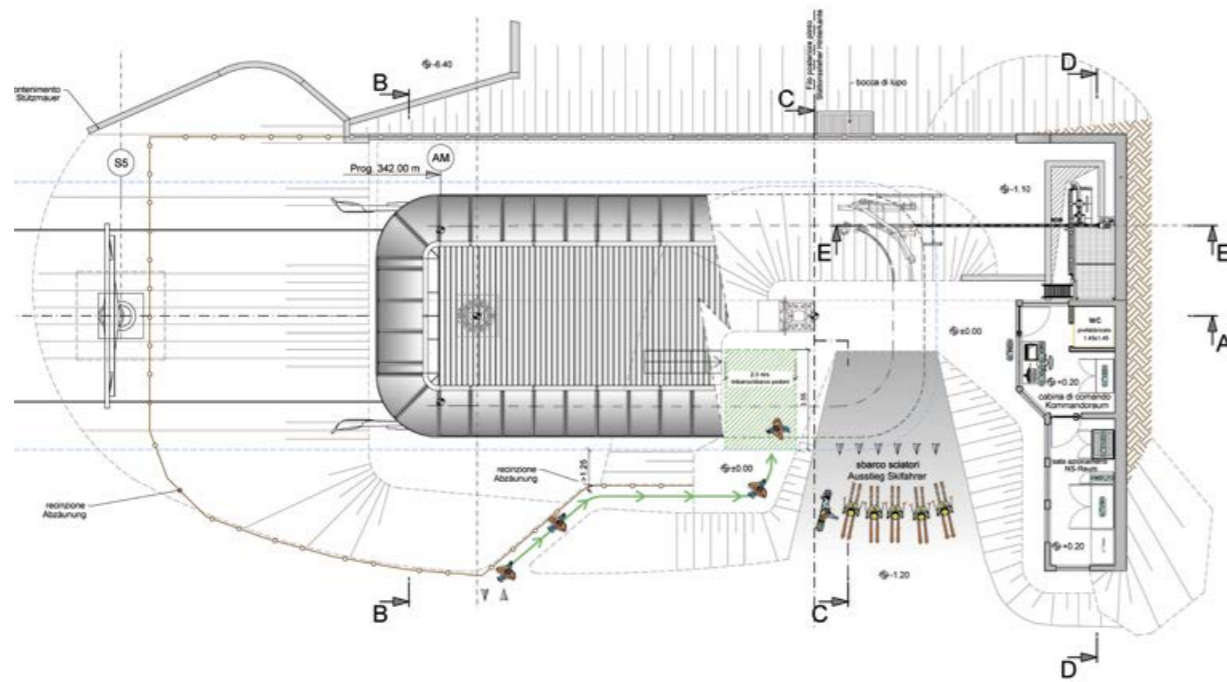





CD6 LA FRAINA

La Villa - Pedraces / IT

Inclined length	761 m	Power	285 kW
Vertical rise	210 m	Total number of vehicles	38
Transport capacity	2400 p/h	Total number of towers	8

The automatically detachable six-seater La Fraina chairlift in Alta Badia provides improved links between La Villa and San Cassiano. With a transport capacity of 2,400 people per hour, the scope of transport services in this part of the resort will increase, helping to reduce waiting times even further. This new ropeway

offers state-of-the-art technology thanks to the DirectDrive system from LEITNER ropeways. The Alta Badia ski resort, which has long been one of the top resorts in the Alps, has a long-standing partnership with LEITNER ropeways spanning almost 70 years.

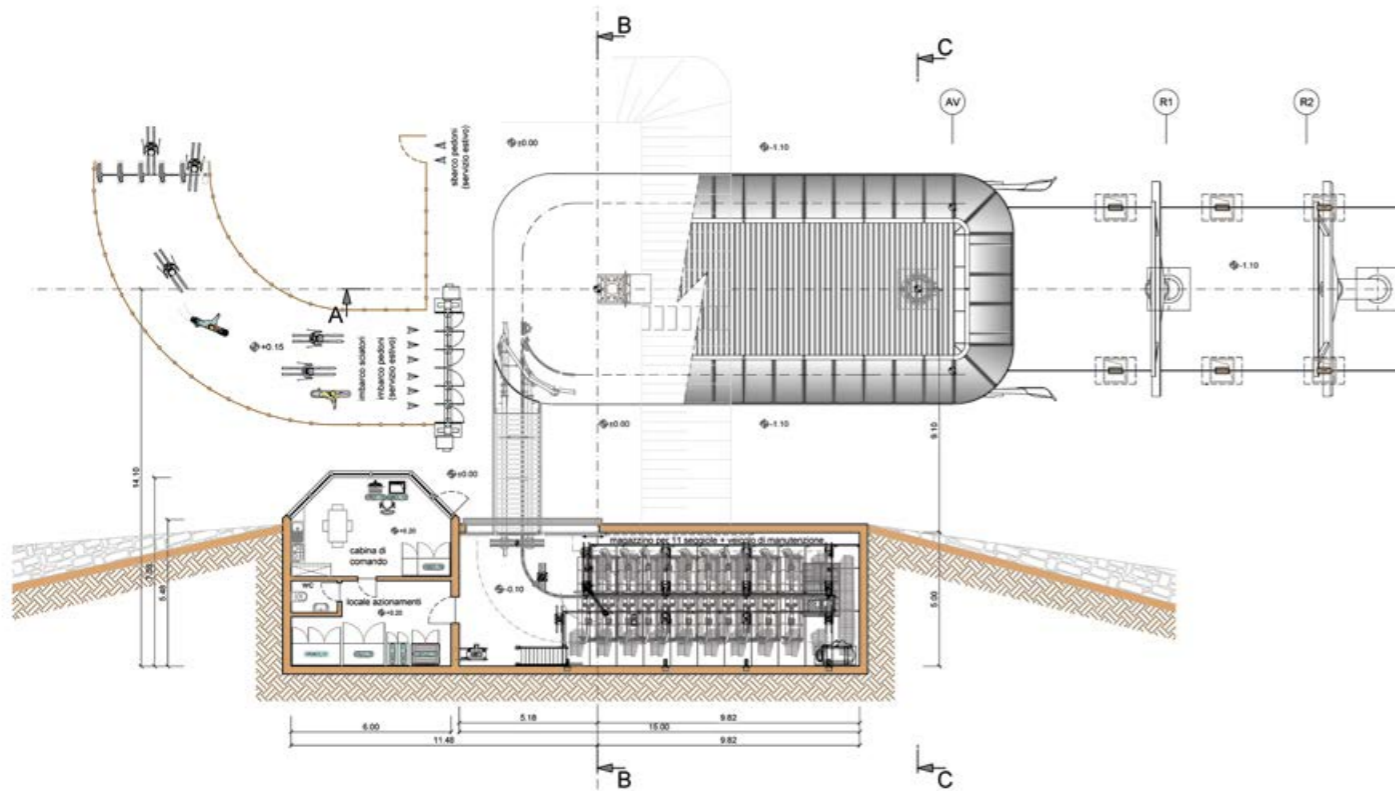





CD6 ARABBA FLY

Arabba - Livinallongo del Col di Lana / IT

Inclined length	424 m	Power	135 kW
Vertical rise	31 m	Total number of vehicles	26
Transport capacity	2650 p/h	Total number of towers	5

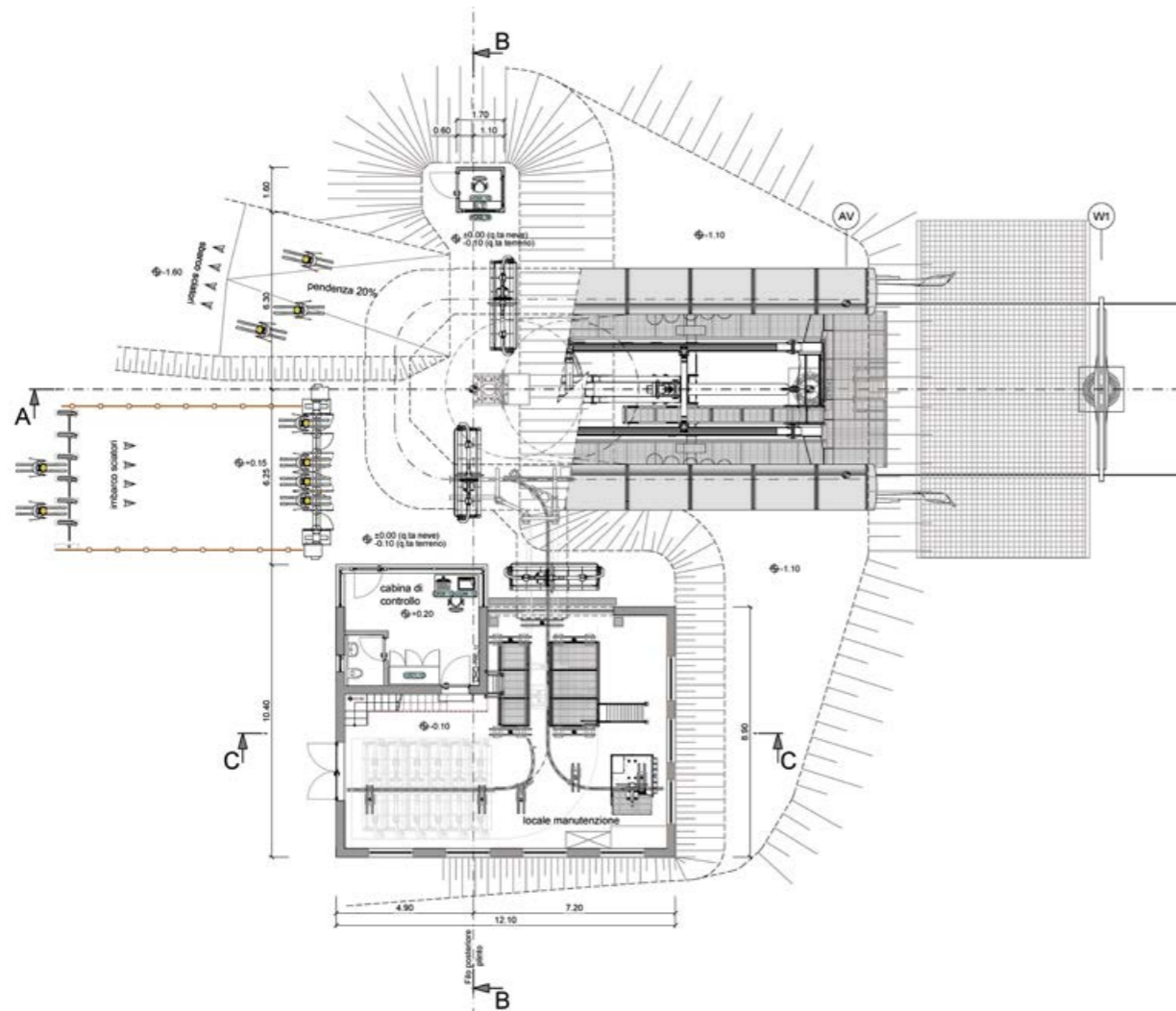





CD6 HOVDE-EXPRESS

Vemdalen / SE

Inclined length	585 m	Power	300 kW
Vertical rise	218 m	Total number of vehicles	28
Transport capacity	2200 p/h	Total number of towers	9

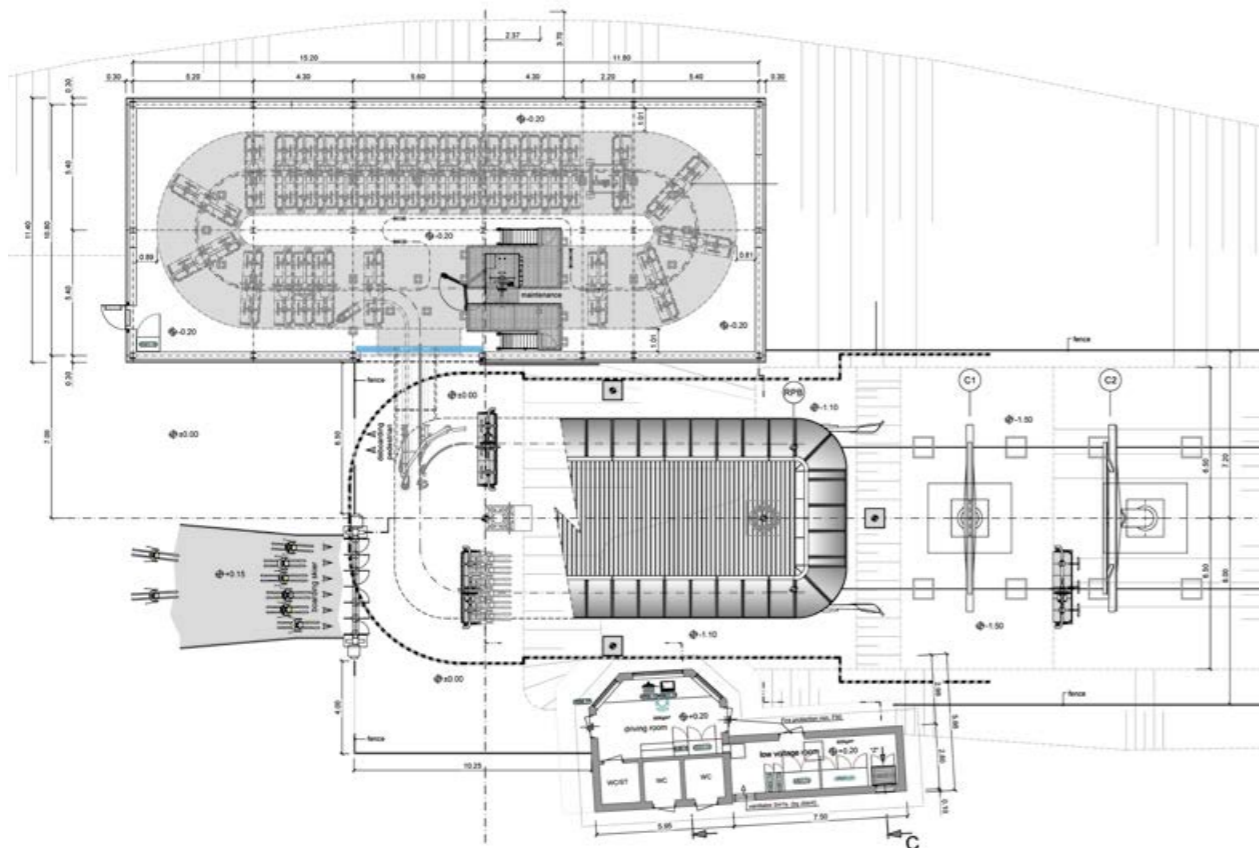





CD6 ROMME SYD

Borlänge / SE

Inclined length	673 m	Power	290 kW
Vertical rise	184 m	Total number of vehicles	47
Transport capacity	3200 p/h	Total number of towers	8

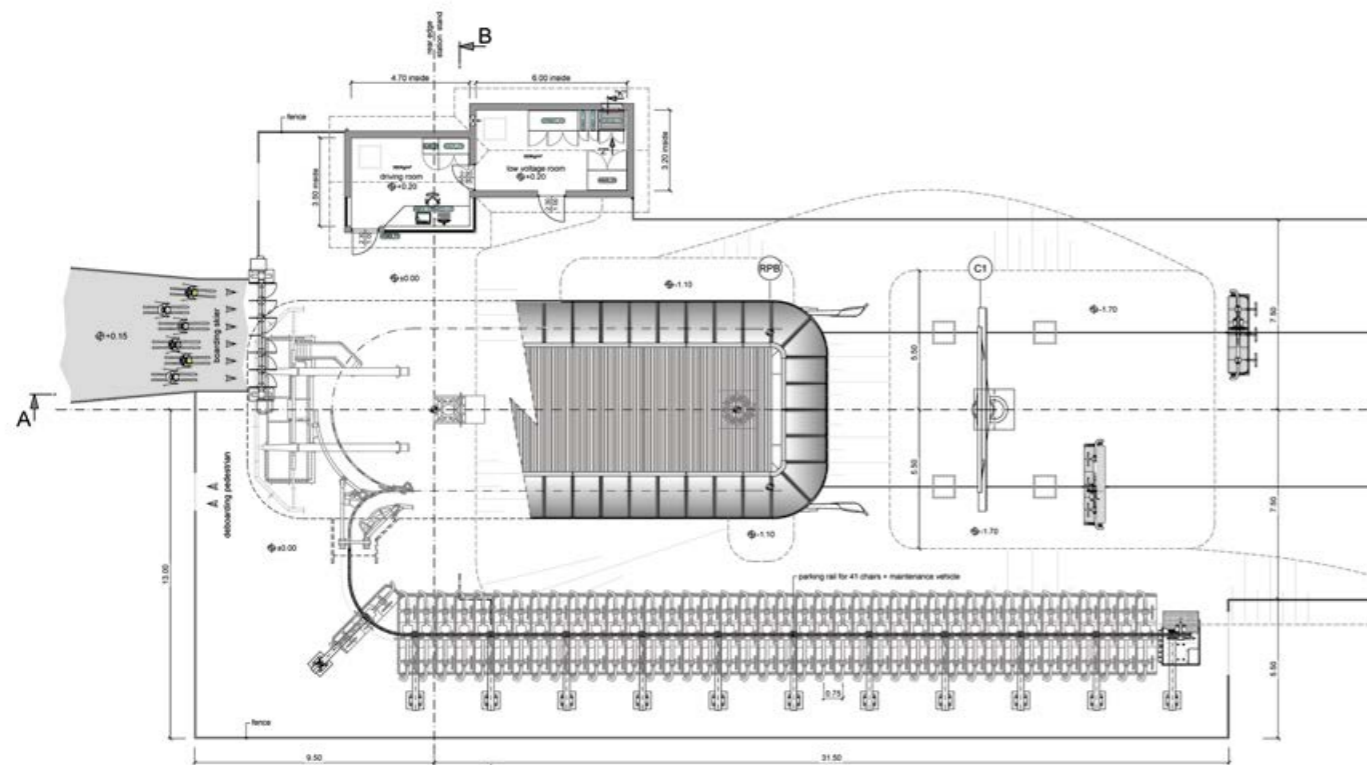





CD6 DUNDRET

Gällivare / SE

Inclined length	1113 m	Power	380 kW
Vertical rise	333 m	Total number of vehicles	55
Transport capacity	2400 p/h	Total number of towers	12

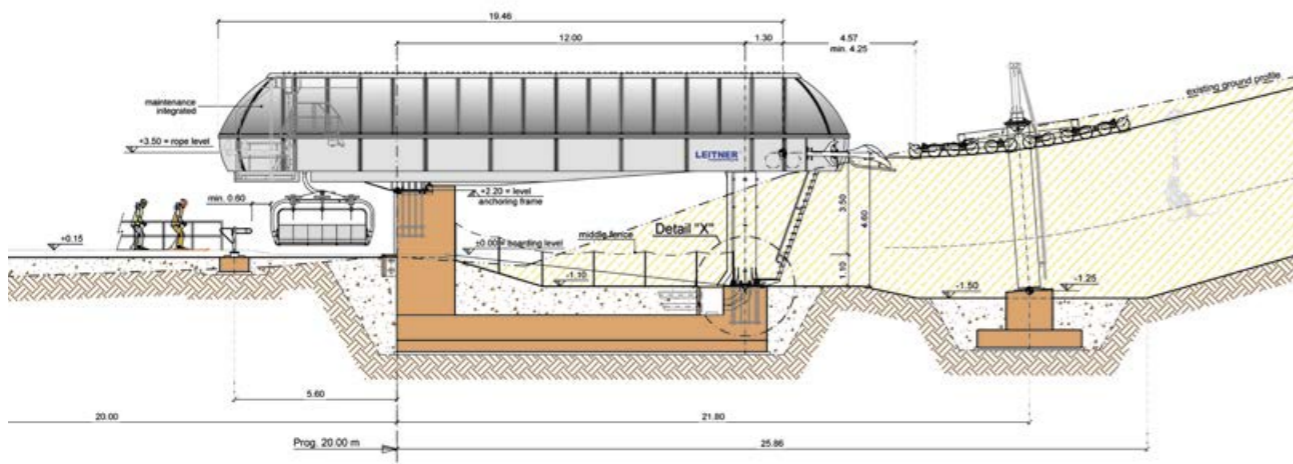





CD6C HOFMANKY EXPRESS

Janské Lázně / CZ

Inclined length	1146 m	Power	390 kW
Vertical rise	306 m	Total number of vehicles	52
Transport capacity	2600 p/h	Total number of towers	9

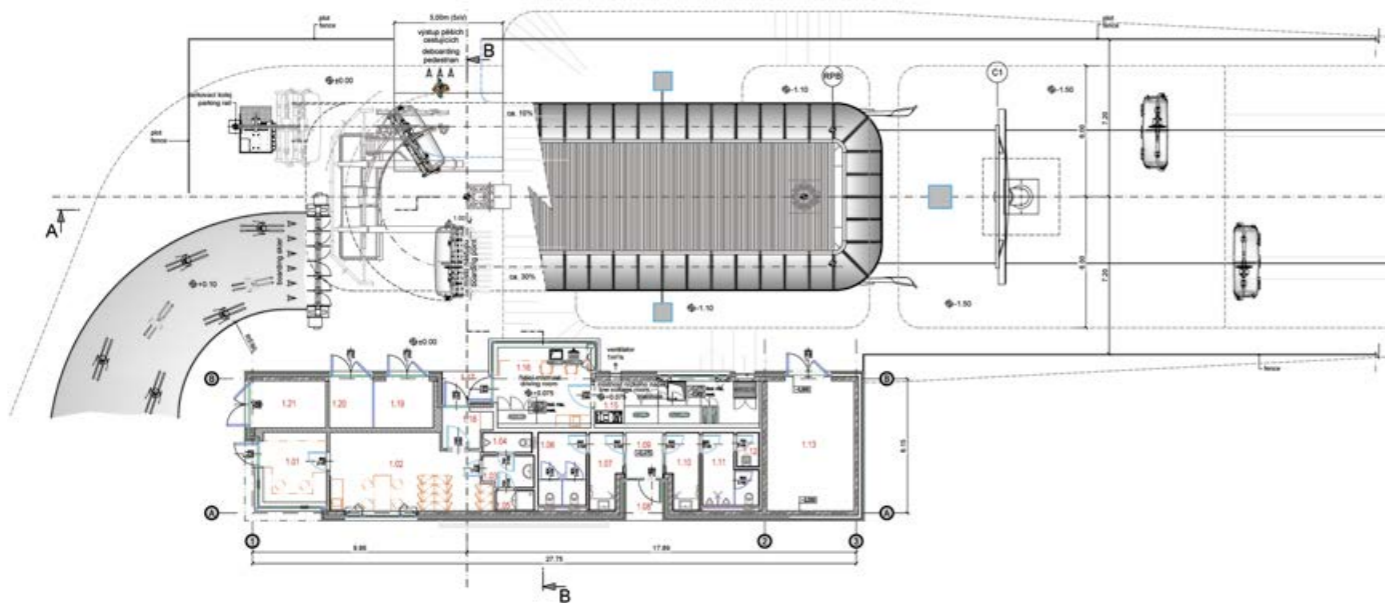





CD6C PLÁŇ

Špindlerův Mlýn / CZ

Inclined length	1576 m	Power	667 kW
Vertical rise	441 m	Total number of vehicles	78
Transport capacity	3000 p/h	Total number of towers	14

Špindlerův Mlýn is one of the Czech Republic's largest and most prominent ski resorts. This popular region in the Giant Mountains is home to 15 ropeways with a total of almost 25 kilometers of ski slopes and also offers FIS-homologated racecourses. Using state-of-the-art technology, LEITNER ropeways has brought increased comfort and shorter waiting times

to Špindlerův Mlýn. The CD6C Pláň ropeway will replace an old four-seater chairlift and offer the full range of features for enhanced comfort with blue hoods, and black and blue padding with heated seats and individual foot rests. The unique DirectDrive system will also be used in Špindlerův Mlýn, along with automatic garaging.

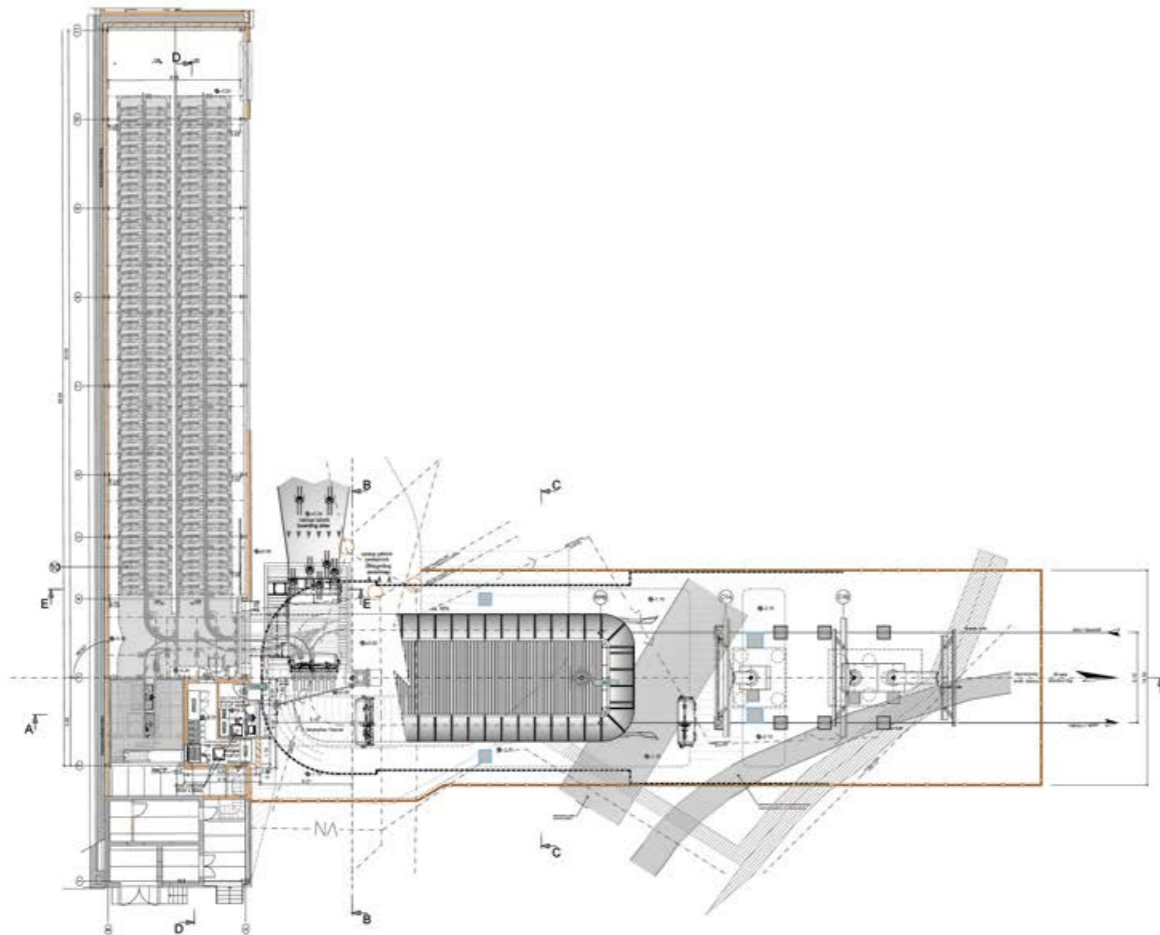





CD6 DU CARRELEY

Les Arcs / FR

Inclined length	1972 m	Power	779 kW
Vertical rise	594 m	Total number of vehicles	97
Transport capacity	3000 p/h	Total number of towers	18

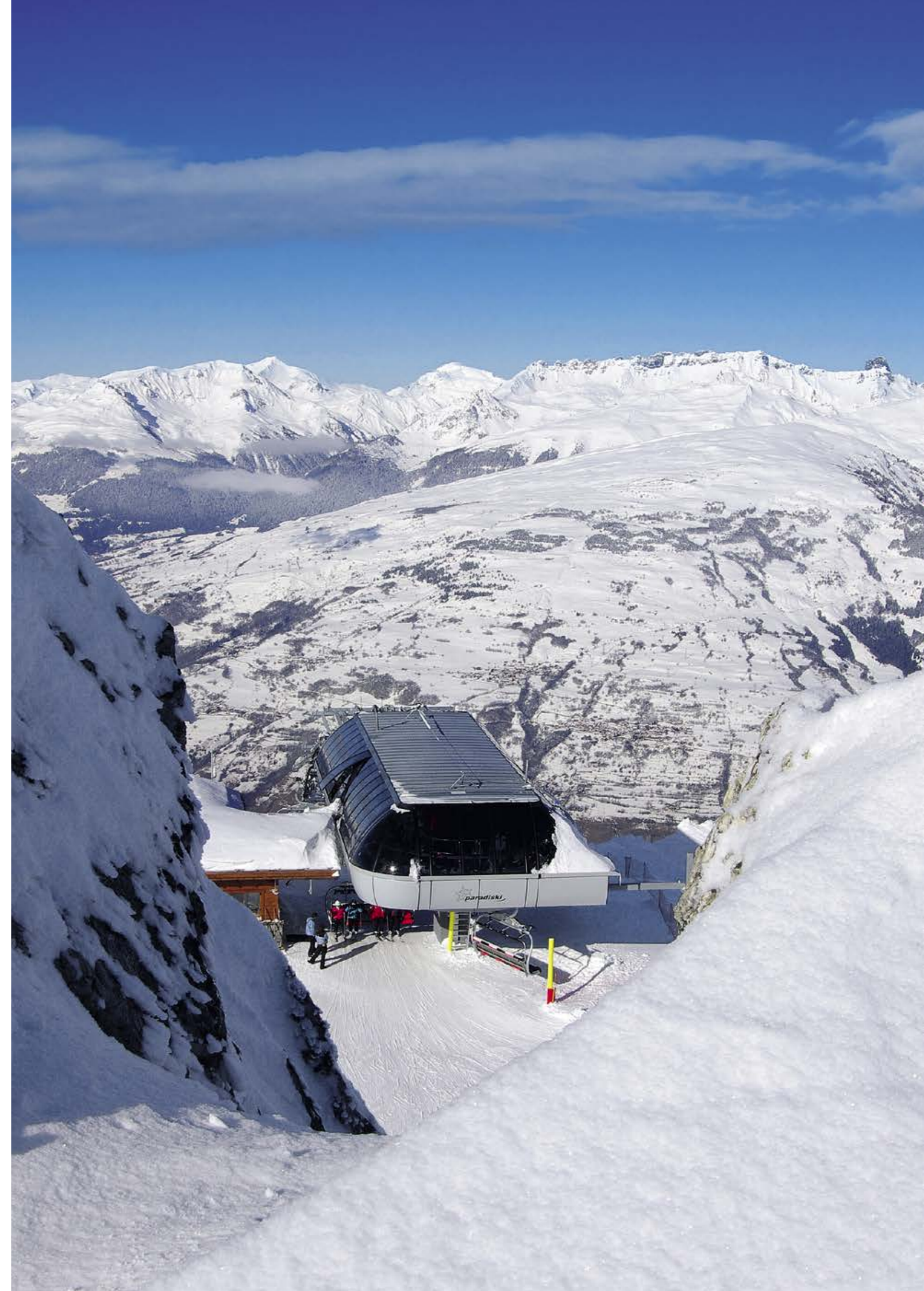
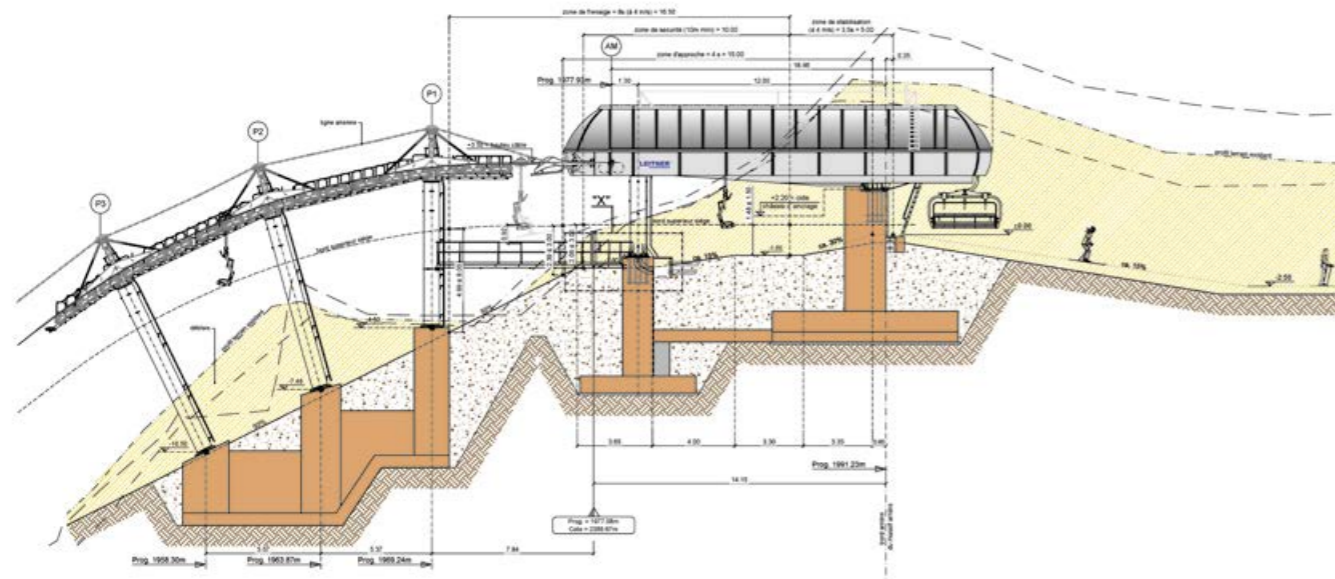





CD6 TODORKA

Bansko / BG

Inclined length	2298 m	Power	647 kW
Vertical rise	702 m	Total number of vehicles	75
Transport capacity	2000 p/h	Total number of towers	15

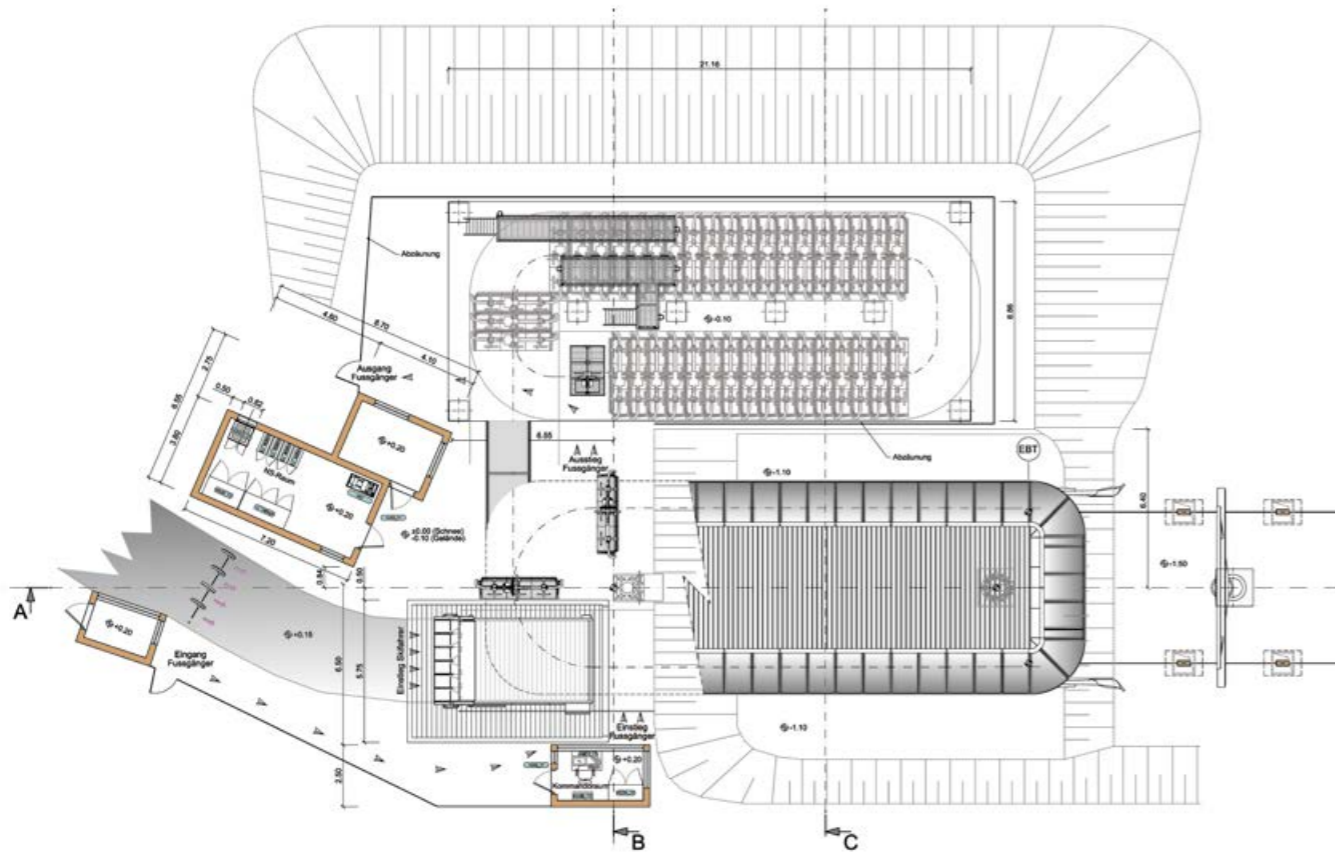



CD4C JAUFEN LIFT

Ratschings - Jaufen / IT

Inclined length	904 m	Power	300 kW
Vertical rise	191 m	Total number of vehicles	67
Transport capacity	2400 p/h	Total number of towers	8

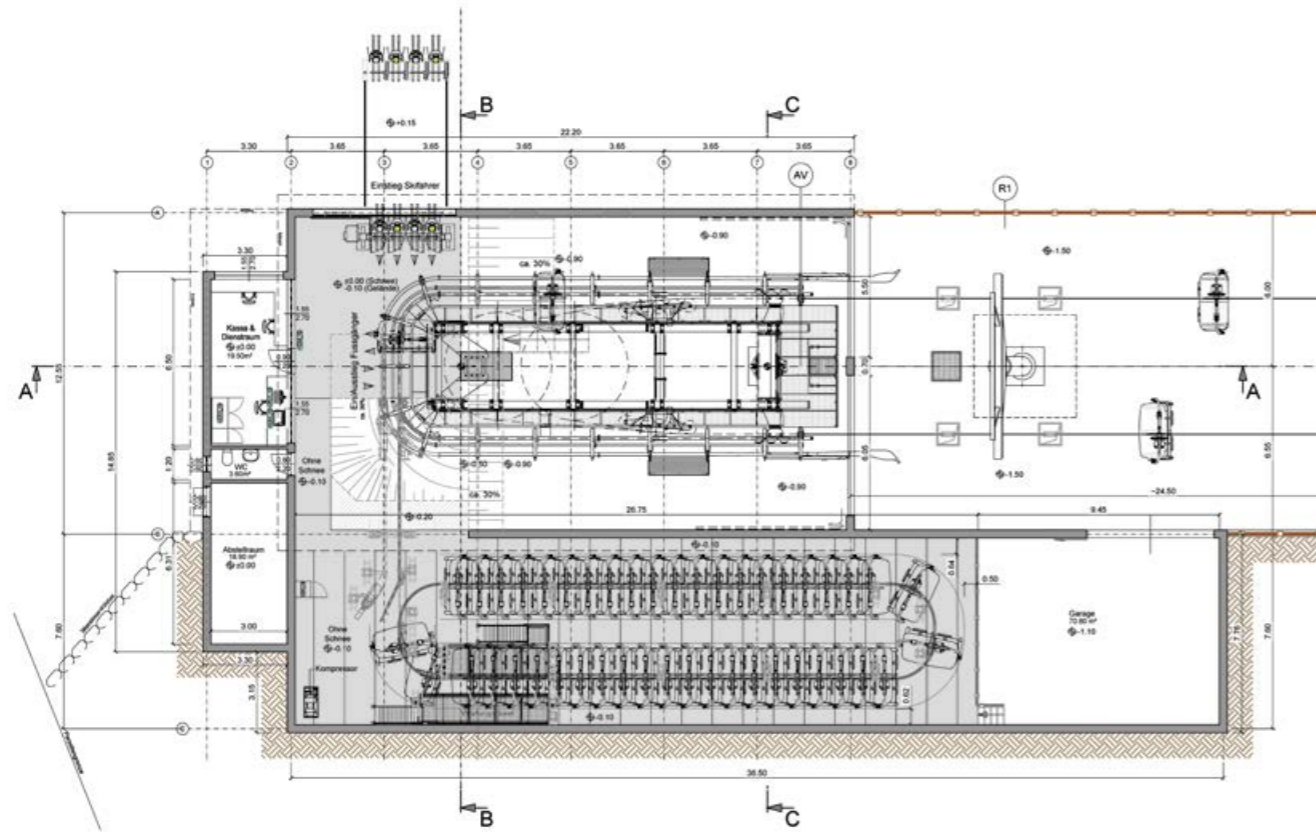





CD4C VALBIONE - DOSS DELLE PERTICHE

Ponte di Legno / IT

Inclined length	1084 m	Power	380 kW
Vertical rise	369 m	Total number of vehicles	80
Transport capacity	2400 p/h	Total number of towers	10

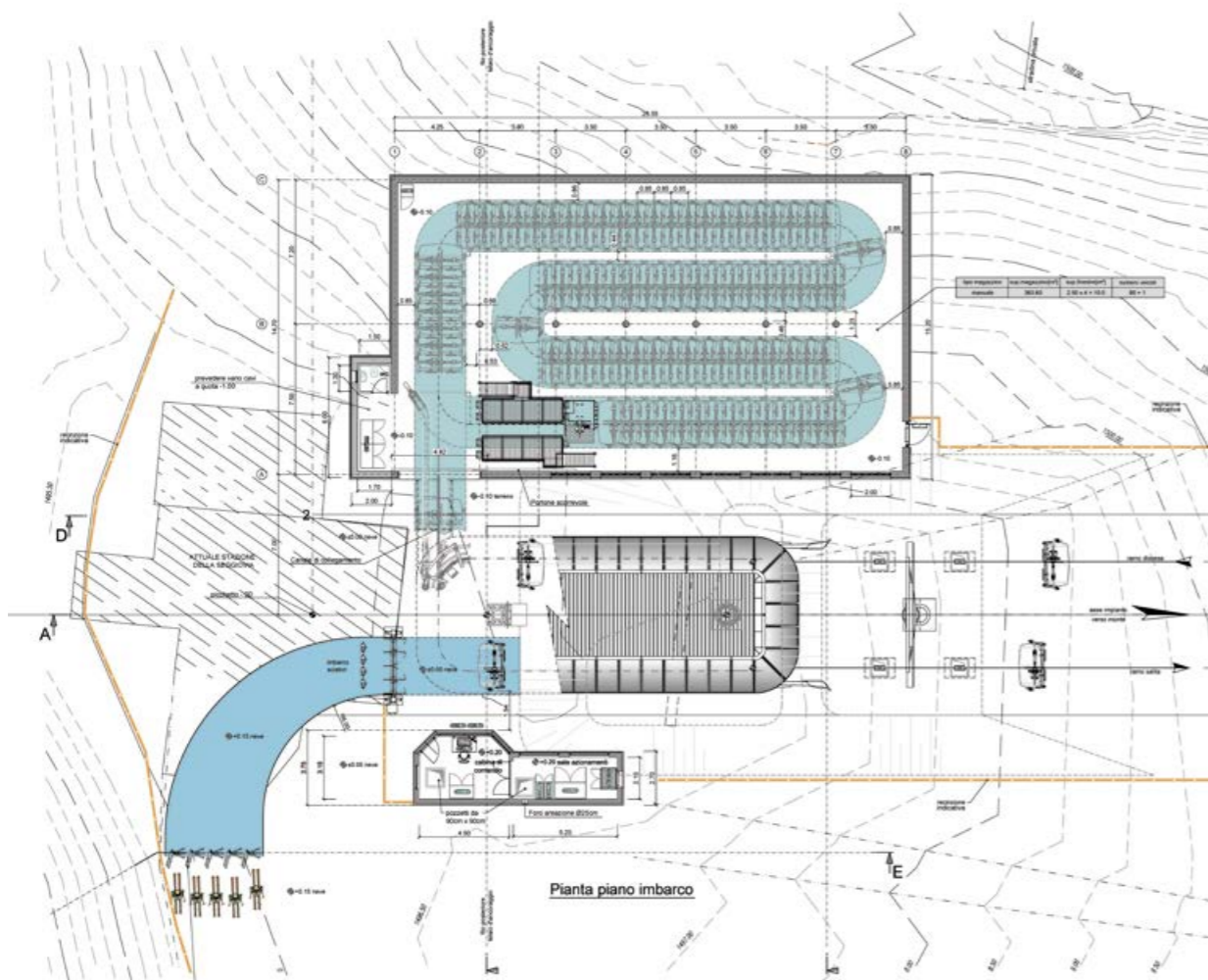





CF2 CAPO D'ACQUA – COLLE DEL MONACO

Campitello Matese / IT

Inclined length	724 m	Power	115 kW
Vertical rise	270 m	Total number of vehicles	99
Transport capacity	1200 p/h	Total number of towers	7

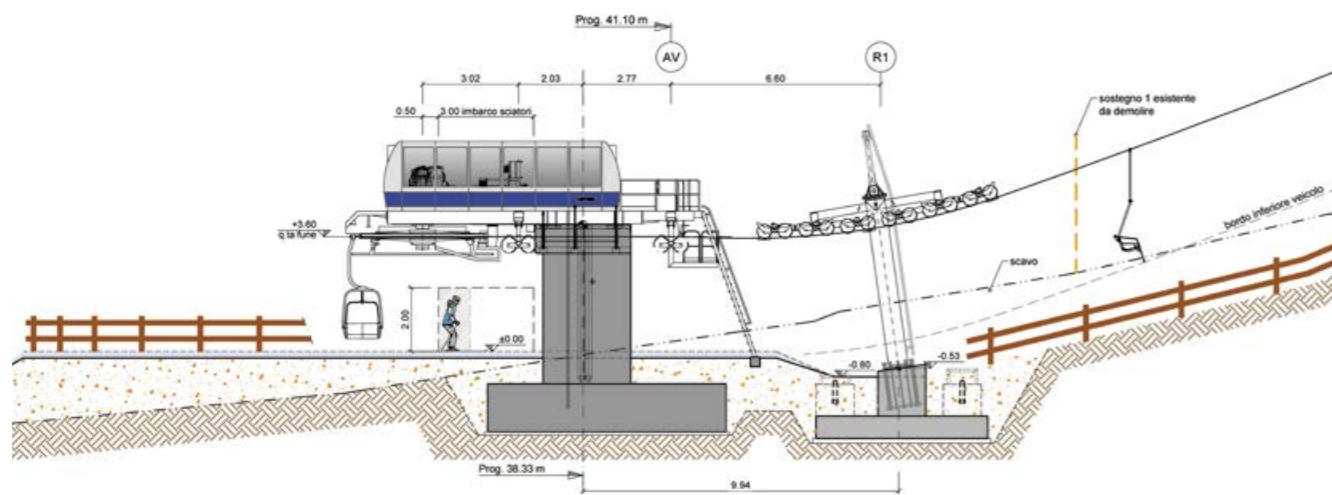



CF2 BICHLALM

Kitzbühel / AT

Inclined length	2255 m	Power	108 kW
Vertical rise	693 m	Total number of vehicles	101
Transport capacity	400 p/h	Total number of towers	18

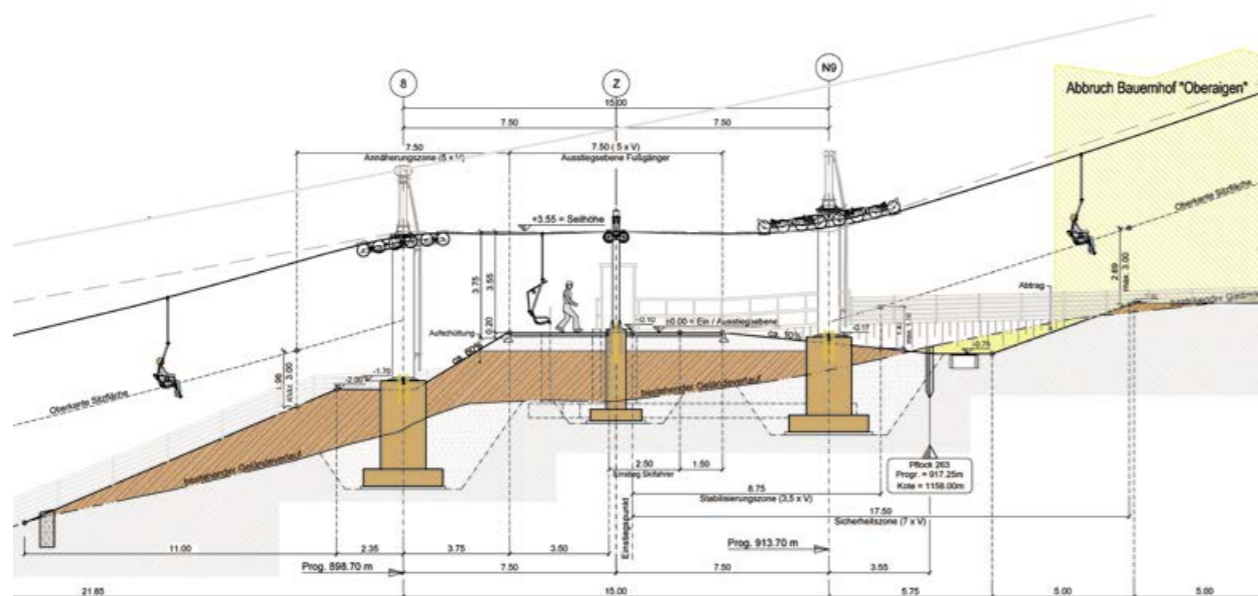







Successes 2015





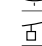

Successes 2015



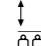

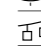
 GD10 SOGN MARTIN - LA SIALA
 Laax / CH

	3366 m
	832 m
	2400 p/h
	860 kW
	84
	18



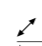
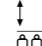

 GD8 DENIZLI
 Denizli / TR

	1610 m
	625 m
	948 p/h
	334 kW
	24
	9

 CD6 ARABBA FLY
 Arabba - Livinallongo del
 Col di Lana / IT

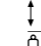
	424 m
	31 m
	2650 p/h
	135 kW
	26
	5

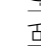

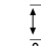
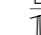

 CD6C HOFMANKY EXPRESS
 Janské Lázně / CZ

	1146 m
	306 m
	2600 p/h
	390 kW
	52
	9



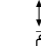

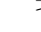
 CD6 HOVDE-EXPRESS
 Vemdalen / SE

	585 m
	218 m
	2200 p/h
	300 kW
	28
	9





 CF2 SINPAS
 Ankara / TR

	166 m
	45 m
	1200 p/h
	18/16 kW
	45
	3



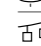

 GD10 MIO CABLE
 Santiago de Cali / CO

	2037 m
	65 m
	3000 p/h
	525 kW
	90
	14



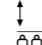

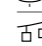
 CD8C BRUNN
 Kitzbühel / AT

	1462 m
	432 m
	3300 p/h
	775 kW
	62
	17

 CD6C SCHERNTHANNBAHN
 Hopfgarten im Brixental / AT

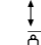
	1273 m
	387 m
	2365 p/h
	427 kW
	61
	11



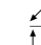
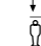
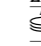
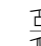
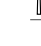

 CD6C ZEIGERBAHN
 St. Blasien / DE

	1188 m
	203 m
	2400 p/h
	296 kW
	59
	9



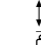
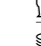

 CD4C VALBIONE -
 DOSS DELLE PERTICHE
 Ponte di Legno / IT

	1084 m
	369 m
	2400 p/h
	380 kW
	80
	10



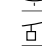

 SL2 SYÖTE
 Oulu / FI

	418 m
	61 m
	1200 p/h
	30 kW
	45
	4



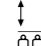

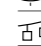
 GD10 YENIMAHALLE III
 Ankara / TR

	1879 m
	72 m
	2400 p/h
	700 kW
	54
	13



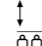

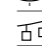
 CD8 POPPENBERG
 Winterberg / DE

	472 m
	103 m
	4000 p/h
	280 kW
	37
	6



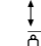

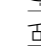
 CD6 TODORKA
 Bansko / BG

	2298 m
	702 m
	2000 p/h
	647 kW
	75
	15



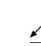
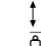

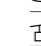
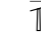
 CD6 CARRELEY
 Les Arcs / FR

	1972 m
	594 m
	3000 p/h
	779 kW
	97
	18



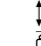

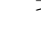
 CD4C JAUFEN LIFT
 Ratschings - Jaufen / IT

	904 m
	191 m
	2400 p/h
	300 kW
	67
	8



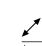

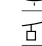
 SL1 BADNATREKKET 2
 Myrkdalen / NO

	317 m
	46 m
	755 p/h
	17 kW
	55
	4



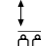

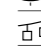
 GD8 PASSO PARADISO -
 PASSO PRESENA
 Vermiglio - Passo Tonale / IT

	2118 m
	404 m
	1875 p/h
	445 kW
	47
	11



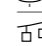

 CD6 PIZ SELLA II
 Selva Val Gardena -
 Plan de Gralba / IT

	325 m
	86 m
	2800 p/h
	170 kW
	26
	5



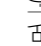

 CD6C JOSCHT - HIRLI
 Zermatt / CH

	2124 m
	699 m
	2000 p/h
	611 kW
	72
	17

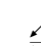
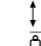

 CD6 DUNDRET
 Gällivare / SE

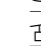
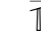
	1113 m
	333 m
	2400 p/h
	380 kW
	55
	12

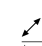

 CF2 CAPO D'ACQUA -
 COLLE DEL MONACO
 Campitello Matese / IT

	724 m
	270 m
	1200 p/h
	115 kW
	99
	7

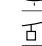

 GD8 SINAIA
 Furnika Peak / RO

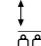
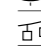
	2068 m
	630 m
	1514 p/h
	507 kW
	42
	12



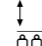
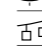

 CD6 LA FRAINA
 La Villa - Pedraces / IT

	761 m
	210 m
	2400 p/h
	285 kW
	38
	8



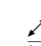

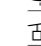
 CD6C PLÁŇ
 Špindlerův Mlýn / CZ



	1576 m
	441 m
	3000 p/h
	667 kW
	78
	14

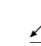
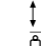

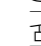
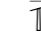

 CD6 ROMME SYD
 Borlänge / SE

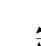
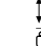
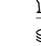
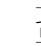
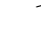
	673 m
	184 m
	3200 p/h
	290 kW
	47
	8

 CF2 BICHLALM
 Kitzbühel / AT

	2255 m
	693 m
	400 p/h
	108 kW
	101
	18

	Inclined length
	Vertical rise
	Transport capacity
	Power
	Total number of vehicles
	Total number of towers

	Winter Sports
	Urban
	Tourism
	Material

LEITNER ropeways



Sterzing (Italy)



Sterzing (Italy)



Telfs (Austria)



Montmélián (France)



Grand Junction (USA)



Stará L'ubovňa (Slovakia)



